

Tybee Creek
(Appx. 1,040' Wide)
EBB
FLOW

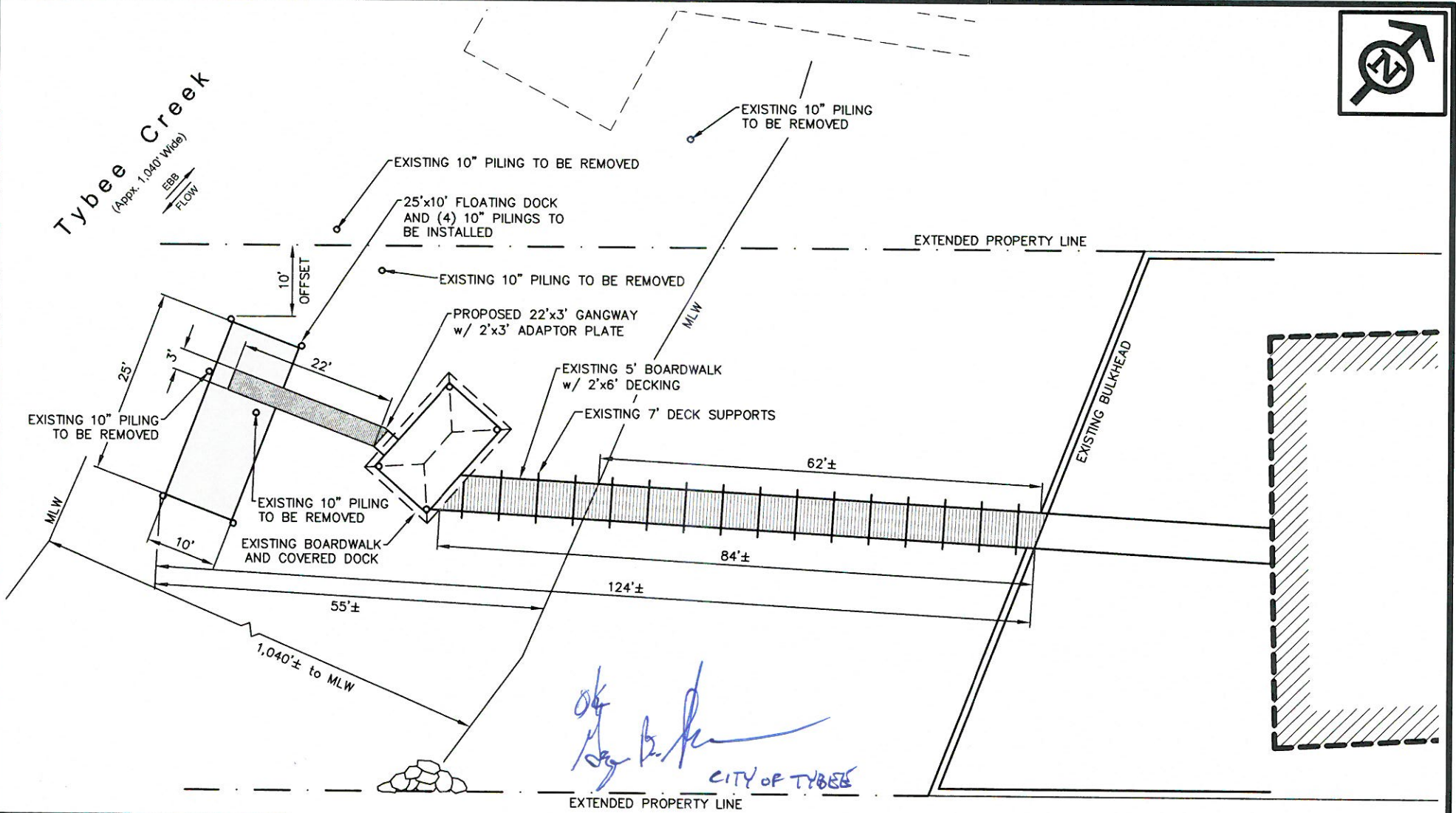

of
John B. Mobley
CITY OF TYBEE



Disclaimer: The information depicted on this figure is for conceptual purposes only, serves to aid a licensed engineer or geologist in rendering professional services, and is subject to review and approval by appropriate regulatory agencies.

ENVIRONMENTAL SERVICES, INC.
7220 Financial Way, Suite 100
Jacksonville, Florida 32256
(904) 470-2200
(904) 470-2112 FAX
31999 ES
www.environmentalservicesinc.com



Site Plan
Hayler Dock Reconstruction
Chatham County, Georgia

Project:	ES18013.00
Date:	Mar 2020
Drwn/Chkd:	JRN/MJD
Figure:	3

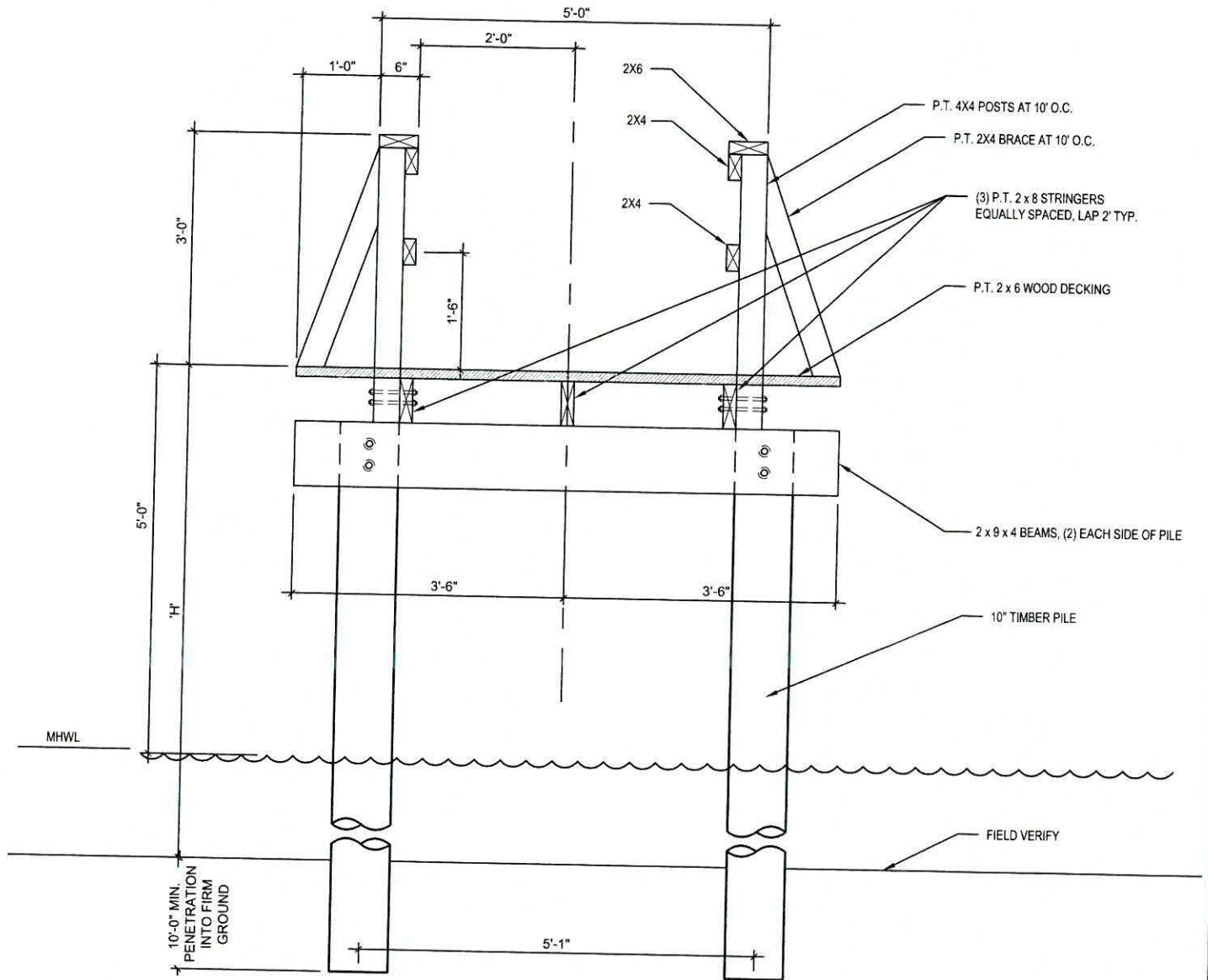

GRADING NOTES:

1) ELEVATIONS SHOWN ABOVE ARE FOR REFERENCE ONLY, 0.0' = EXISTING GRADE ELEVATION. FINAL BOARDWALK ELEVATIONS SHALL BE BUILT TO CLEAR ALL VEGETATION.

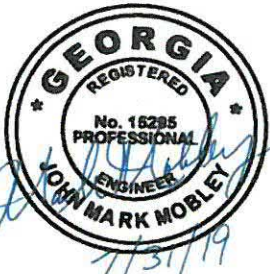

ok
He Bl
9-12-19

NOT TO SCALE

Disclaimer: The Information depicted on this figure is for conceptual purposes only, serves to aid a licensed engineer or geologist in rendering professional services, and is subject to review and approval by appropriate regulatory agencies.

Existing Fixed Dock Cross Section
Hayler Dock Reconstruction
 Chatham County, Georgia

Project: ES18013.00
 Date: July 2019
 Drwn/Chkd: JRN/MJD
 Figure: 4



ENVIRONMENTAL SERVICES, INC.
 7220 Financial Way, Suite 100
 Jacksonville, Florida 32256
 (904) 470-2200
 (904) 470-2112 FAX
 1999 ES
 www.environmentalservicesinc.com