



COASTAL RESOURCES DIVISION
ONE CONSERVATION WAY • BRUNSWICK, GA 31520 • 912.264.7218
COASTALGADNR.ORG

MARK WILLIAMS
COMMISSIONER

DOUG HAYMANS
DIRECTOR

Public Notice

Saturday, January 5, 2019

The Mayor and The Alderman of the City of Savannah Construction of an Elevated Concrete Walkway and Infrastructure Maintenance, Savannah River, Chatham County, Georgia

This serves as notification from the Coastal Marshlands Protection Committee and the Georgia Department of Natural Resources of a request from the Mayor and the Alderman of the City of Savannah for a Coastal Marshlands Protection Act (CMPA) Permit under O.C.G.A. 12-5-280 et. seq. to construct an elevated concrete walkway and replace an existing tide gate along the Savannah River, Chatham County, Georgia.

The applicant is proposing the construction and maintenance of approximately +/- 551 linear feet of elevated walkway seaward of the Marriott Hotel that will connect approximately +/- 5,000 linear feet of existing walkway west of the Marriott Hotel to approximately +/- 2,050 feet of existing elevated walkway east of the Marriott Hotel. An existing tide gate structure located west of the Marriott will also be replaced in association with this project.

As proposed, four (4) sections of pile supported concrete walkway will be constructed as part of this project. Section 1 will measure approximately 12ft. X 172ft. (2,064sq.ft. or 0.047 acre). Section 2 will measure approximately 17ft. X 115ft. (1,955sq.ft. or 0.045 acre). Section 3 will measure approximately 12ft. X 198ft. (2,376sq.ft. or 0.055 acre). Section 4 will measure approximately 12ft. X 66ft. (792sq.ft. or 0.018 acre). Total impacts associated with the proposed pile supported concrete walkway are approximately 7,187sq.ft. (0.165 acre). Replacement of the existing tide gate will not result in any additional impacts to coastal marshlands. The structure will extend approximately 66ft. into the Savannah River at a point where the river is approximately 825ft. from Mean Low Water (MLW) to MLW. As proposed, the elevated walkway will be approximately 185ft. from the federally maintained navigational channel.

The applicant has stated that the proposed project does not contain an upland component.

It is the responsibility of the applicant to demonstrate that the project is not contrary to the public interest and that no feasible alternative sites exist. Impacts to coastal marshlands must be minimal in size. In passing upon the application for permit, the Coastal Marshlands Protection Committee shall consider the public interest: (1) Whether or not unreasonably harmful obstruction to or alteration of the natural flow of navigational water within the affected area will arise as a result of the proposal; (2) Whether or not unreasonably harmful or increased erosion, shoaling of channels, or stagnant areas of water will be created; and (3) Whether or not the granting of a permit and the completion of the applicant's proposal will unreasonably interfere with the conservation of fish, shrimp, oysters, crabs, clams, or other marine life, wildlife, or other resources, including but not limited to water and oxygen supply.

A detailed public notice with drawings has been distributed and is available by visiting the Division's website: CoastalGaDNR.org under "Marsh & Shore Permits".

Please provide this office with substantive, project-specific comments as to why the proposed work should or should not proceed. Comments and questions concerning this proposed project should be submitted in writing by the close of business February 4, 2019 to Deb Barreiro, Department of Natural Resources, 185 Richard Davis Drive, Suite 104, Richmond Hill, Georgia 31324.

CITY OF *Savannah* GEORGIA

EAST RIVER WALK CONNECTION



MAY 23, 2018
REVISED SEPTEMBER 26, 2018
J-25803.0000



RIVERWALK CONNECTION

CLIENT:
CITY OF SAVANNAH

LOCATION: SAVANNAH, GEORGIA

DATE: MAY 23, 2018

DRAWN BY: JWR

SHEET: 1

JOB NUMBER: J-25803.0000

REVIEWED BY: SHG

SCALE: As Shown

THOMAS & HUTTON
Engineering | Surveying | Planning | GIS | Consulting

50 Park of Commerce Way
Savannah, GA 31405 • 912.234.5300

www.thomasandhutton.com

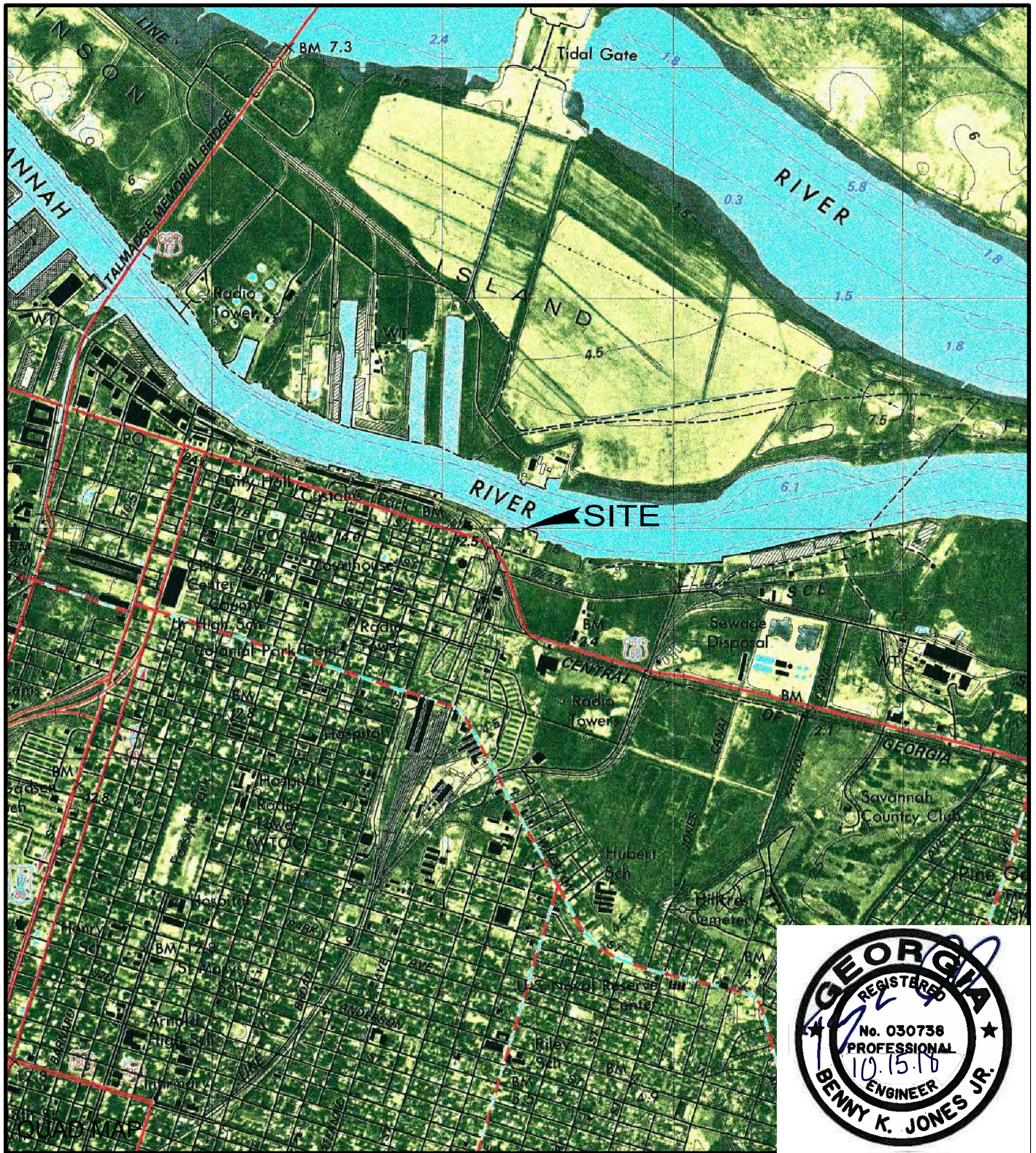

RIVERWALK CONNECTION

QUAD MAP

CLIENT:
CITY OF SAVANNAH

LOCATION: SAVANNAH, GEORGIA

DATE: MAY 23, 2018

DRAWN BY: JWR

SHEET: 2

JOB NUMBER: J-25803.0000

REVIEWED BY: SHG

SCALE: 1"=2000'



50 Park of Commerce Way
Savannah, GA 31405 • 912.234.5300

www.thomasandhutton.com

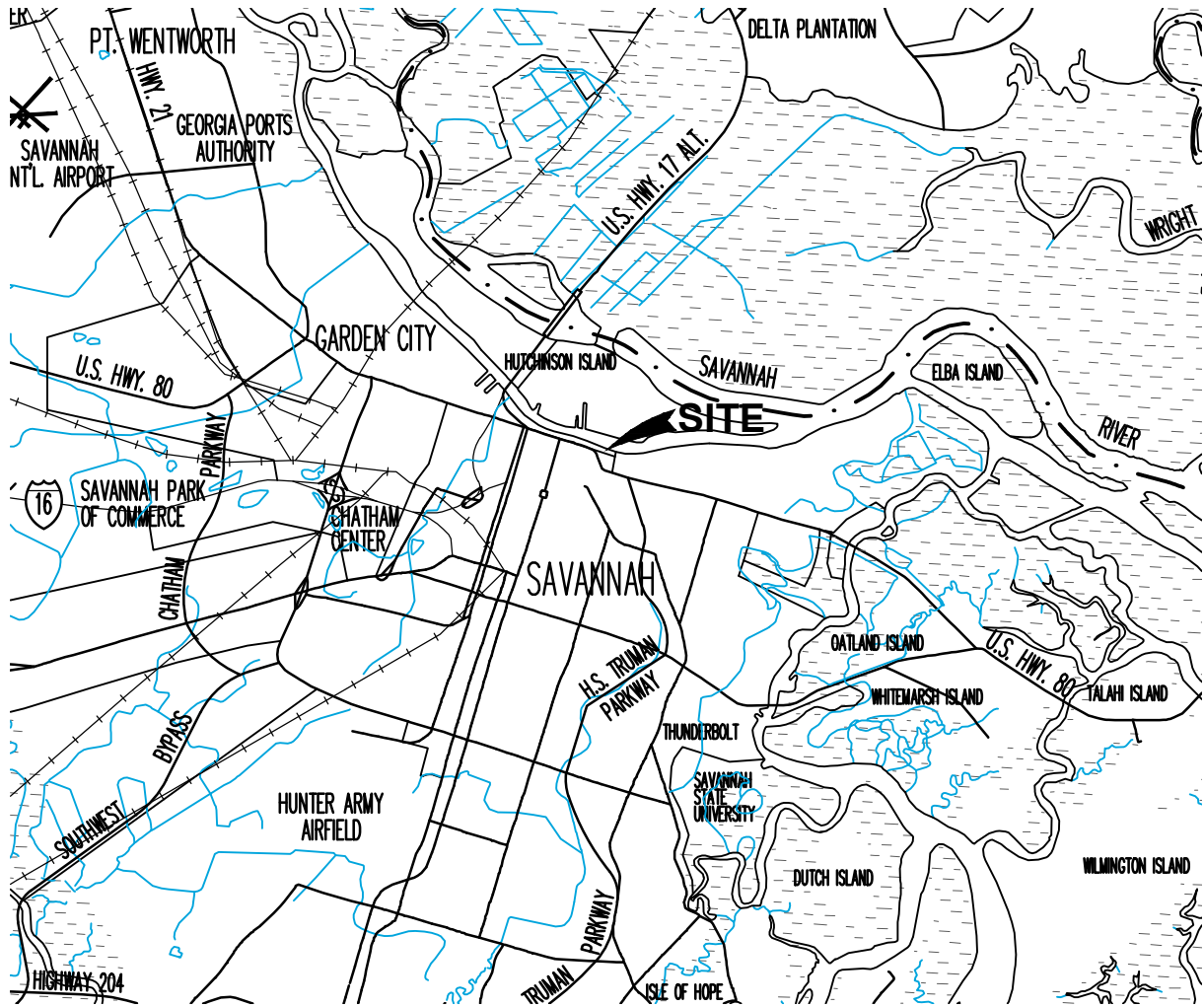

RIVERWALK CONNECTION

VICINITY MAP

CLIENT:
CITY OF SAVANNAH

LOCATION: SAVANNAH, GEORGIA

DATE: MAY 23, 2018 DRAWN BY: JWR SHEET: 3
 JOB NUMBER: J-25803.0000 REVIEWED BY: SHG SCALE: 1" = 1000'



50 Park of Commerce Way
Savannah, GA 31405 • 912.234.5300

www.thomasandhutton.com

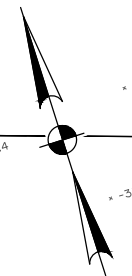
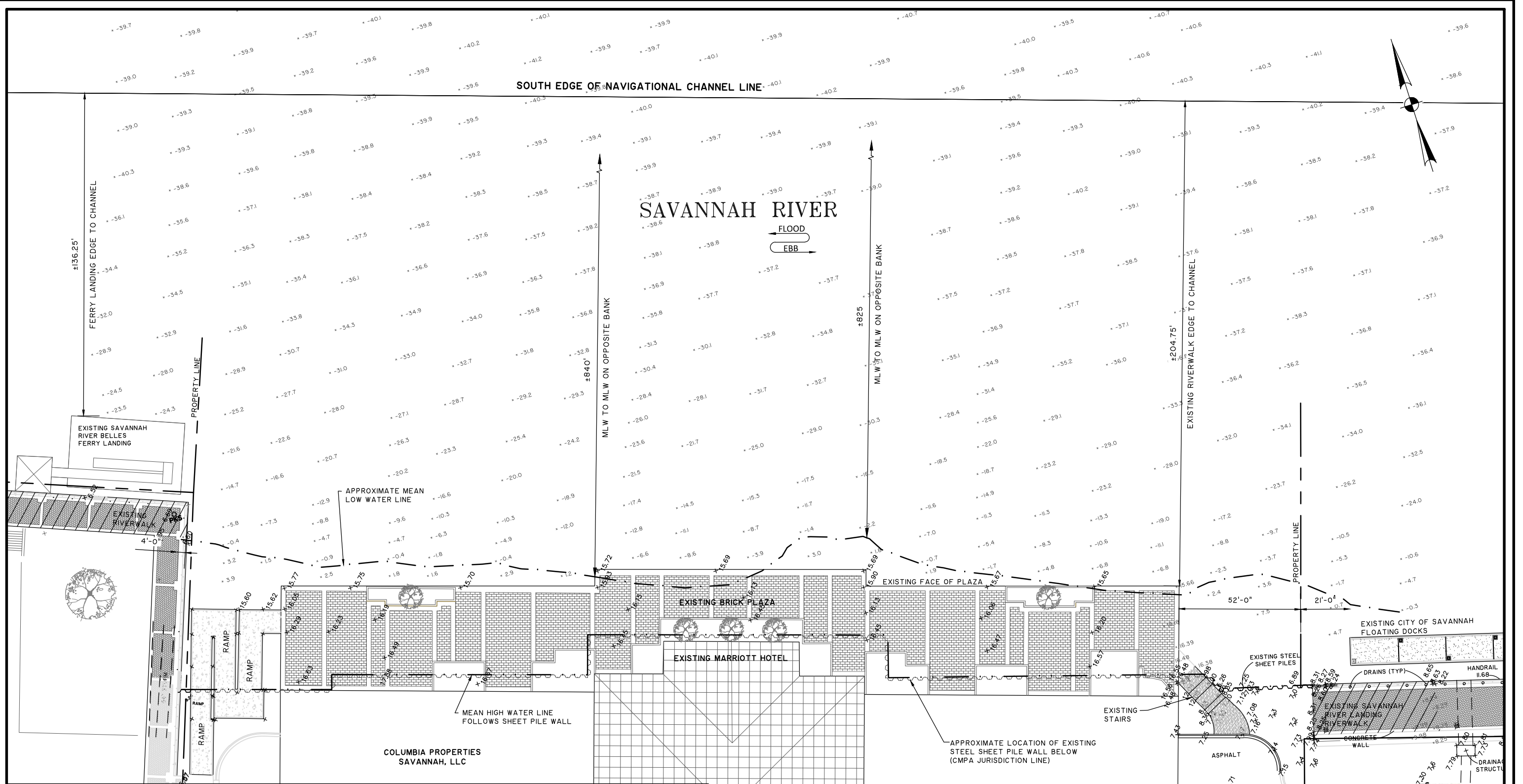

RIVERWALK CONNECTION

EXISTING CONDITIONS
 CLIENT:
CITY OF SAVANNAH
 LOCATION: SAVANNAH, GEORGIA
 DATE: MAY 23, 2018 DRAWN BY: JWR SHEET: 4
 JOB NUMBER: J-25803.0000 REVIEWED BY: SHG SCALE: 1"=40'



50 Park of Commerce Way
 Savannah, GA 31405 • 912.234.5300

www.thomasandhutton.com

DATUM: NAVD 88

NOTES:
 1. HYDROGRAPHIC SURVEY BASED ON MLW DATUM.
 2. SURVEY PERFORMED ON OCTOBER 22, 2015.

REVISED: SEPT. 26, 2018



Z:\25803\25803.0000\Engineering\Drawings\permits\25803 - Riverwalk Permits.dwg - Sep 26, 2018 - 10:27:54 AM

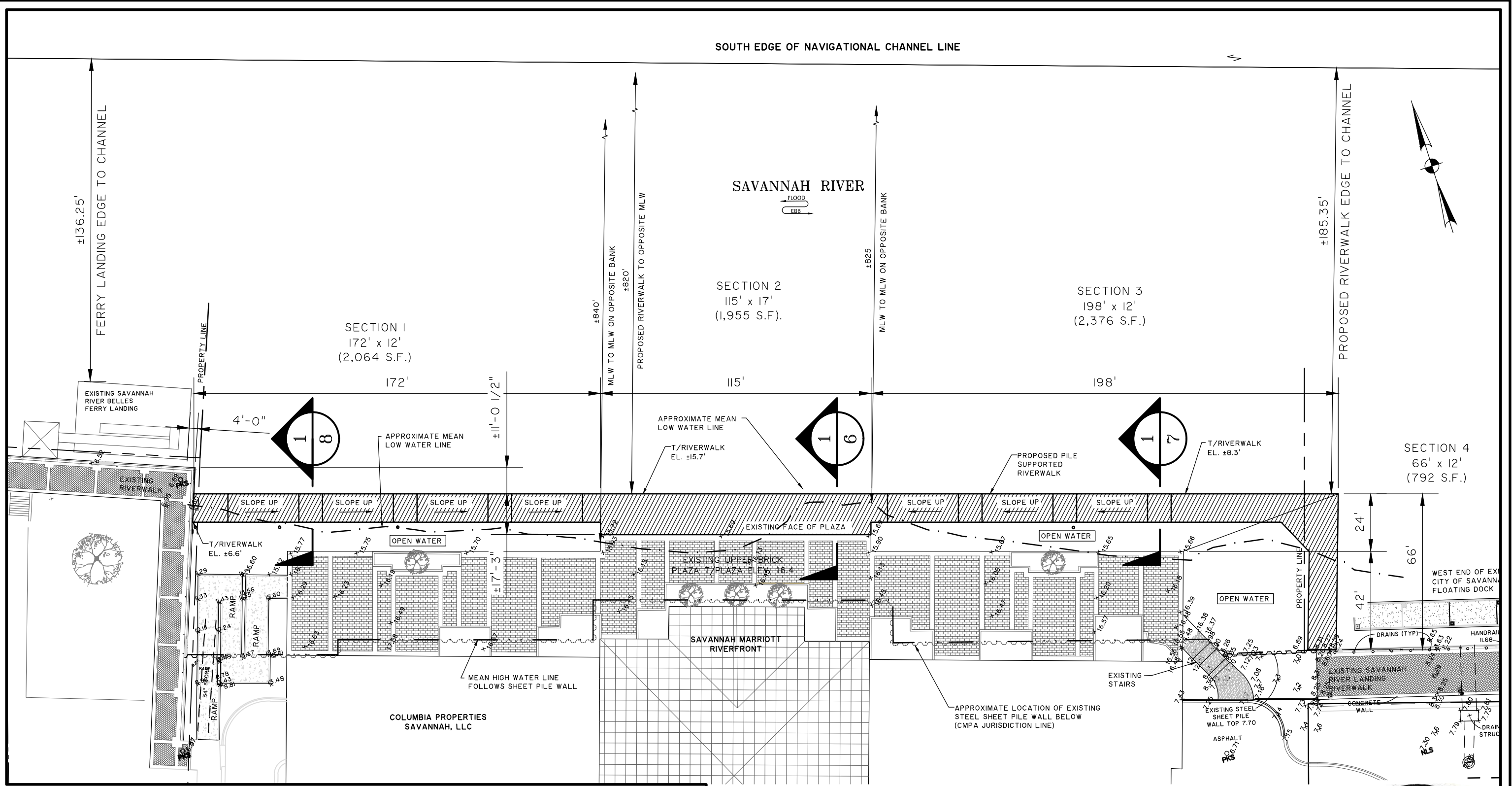

SOUTH EDGE OF NAVIGATIONAL CHANNEL LINE

SAVANNAH RIVER

SECTION 2
115' x 17'
(1,955 S.F.)

SECTION 3
198' x 12'
(2,376 S.F.)

SECTION 1
172' x 12'
(2,064 S.F.)

SECTION 4
66' x 12'
(792 S.F.)

RIVERWALK CONNECTION

PROPOSED RIVERWALK PLAN

CLIENT:
CITY OF SAVANNAH
LOCATION: SAVANNAH, GEORGIA
DATE: MAY 23, 2018
JOB NUMBER: J-25803.0000

DRAWN BY: JWR
REVIEWED BY: SHG

SHEET: 5
SCALE: 1"=40'



50 Park of Commerce Way
Savannah, GA 31405 • 912.234.5300

www.thomasandhutton.com

DATUM: NAVD 88

ACREAGE SUMMARY		
SECTION 1 (172' x 12')	2,064 S.F.	(0.047 AC.)
SECTION 2 (115' x 17')	1,955 S.F.	(0.045 AC.)
SECTION 3 (198' x 12')	2,376 S.F.	(0.055 AC.)
SECTION 4 (66' x 12')	792 S.F.	(0.018 AC.)
TOTAL AREA:	7,187 S.F.	(0.165 AC.)

REVISED: SEPT. 26, 2018



Z:\25803\25803.0000\Engineering\Drawings\permits\25803 - Riverwalk Permits.dwg - Sep 26, 2018 - 10:3:49 AM

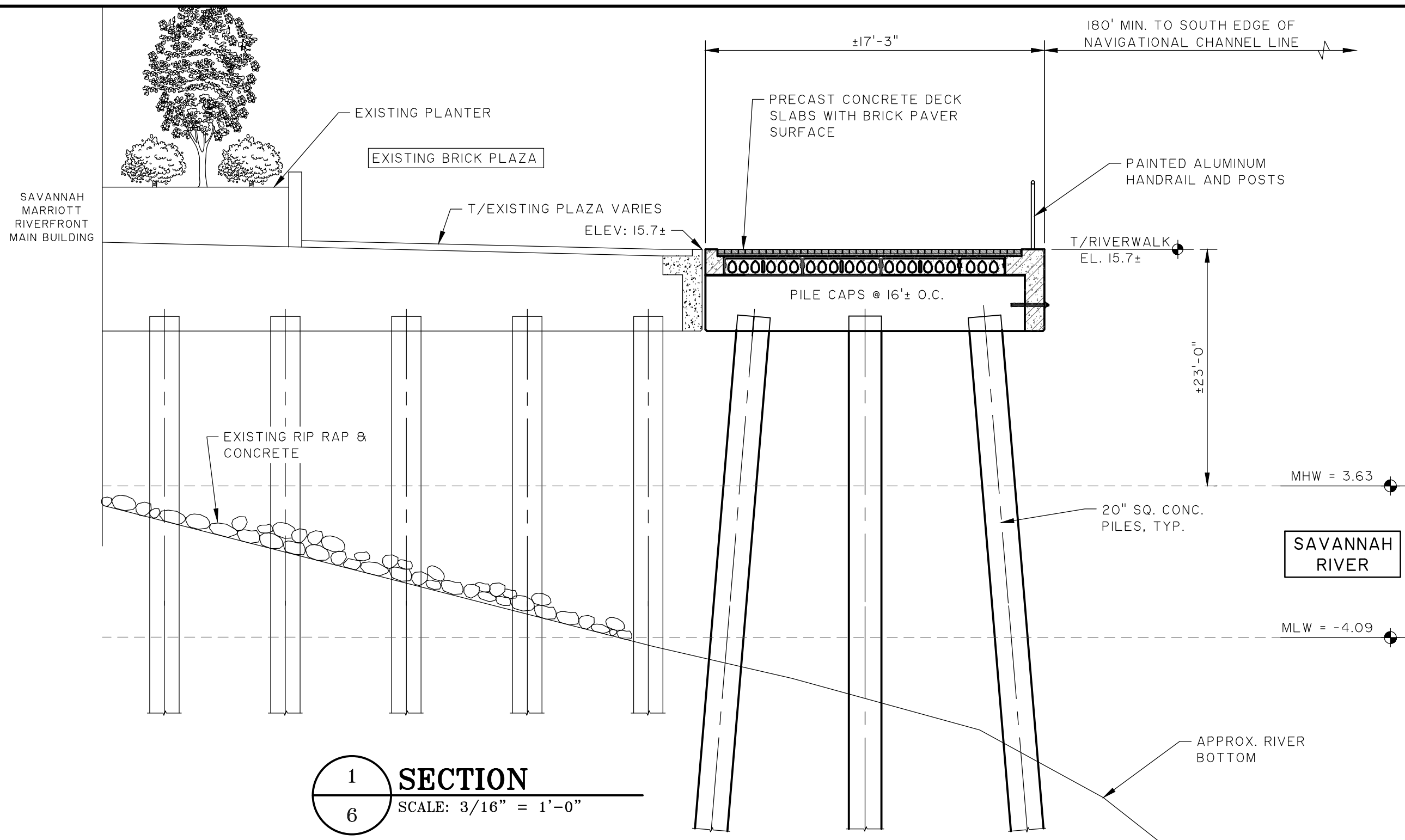

1 SECTION
6 SCALE: 3/16" = 1'-0"

RIVERWALK CONNECTION

SECTION AT EXISTING MARRIOTT PLAZA

CLIENT:
CITY OF SAVANNAH
LOCATION: SAVANNAH, GEORGIA
DATE: MAY 23, 2018 DRAWN BY: JWR SHEET: 6
JOB NUMBER: J-25803.0000 REVIEWED BY: SHG SCALE: AS SHOWN



50 Park of Commerce Way
Savannah, GA 31405 • 912.234.5300

www.thomasandhutton.com

DATUM: NAVD 88

REVISED: SEPT. 26, 2018



Z:\25803\25803.0000\Engineering\Drawings\permits\25803 - Riverwalk Permits.dwg - Sep 26, 2018 - 10:3:49 AM

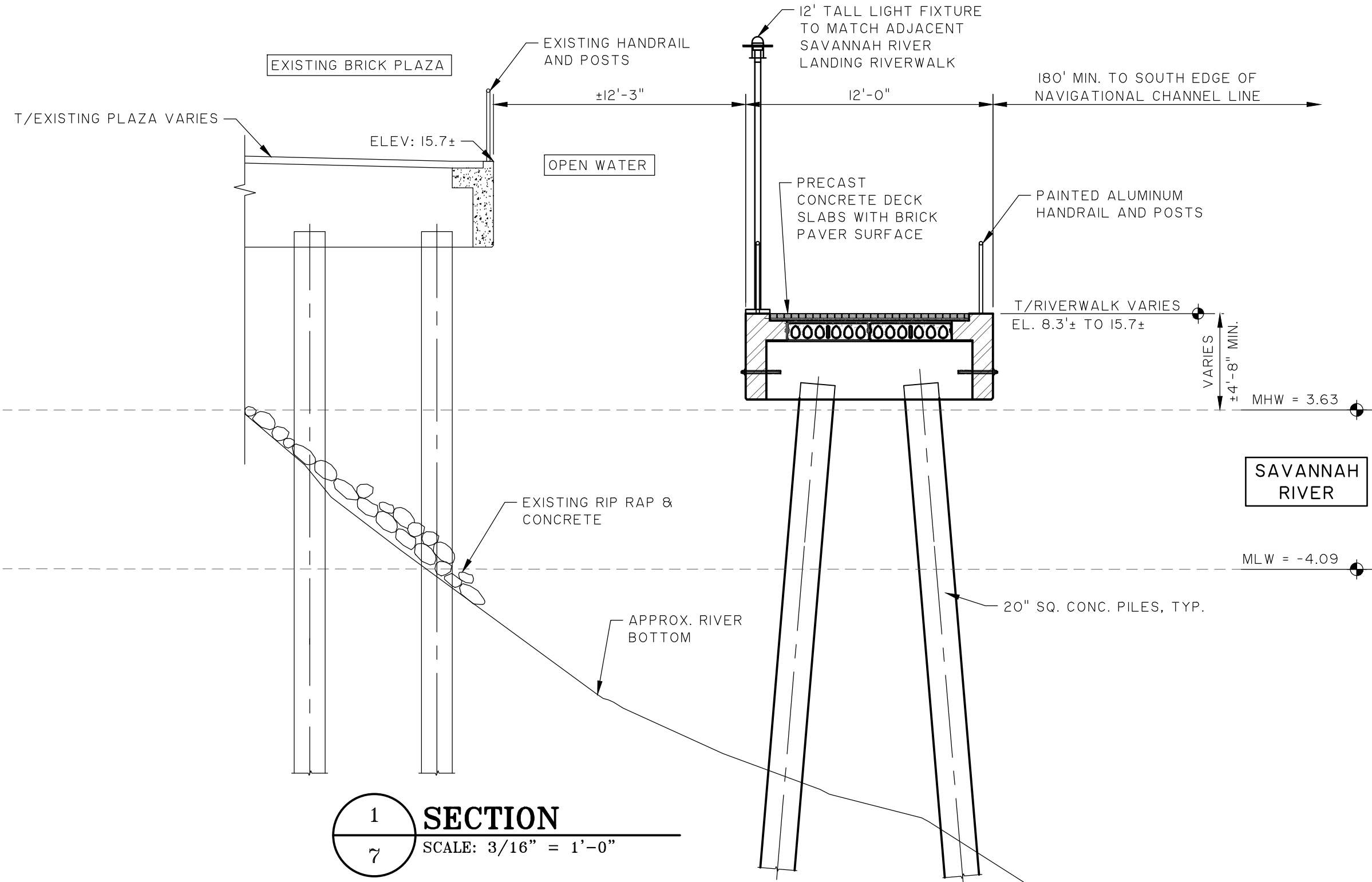

1 SECTION
7 SCALE: 3/16" = 1'-0"

DATUM: NAVD 88

RIVERWALK CONNECTION

SECTION AT 12'-0" WIDTH - EAST SIDE

CLIENT:
CITY OF SAVANNAH

LOCATION: SAVANNAH, GEORGIA
DATE: MAY 23, 2018 DRAWN BY: JWR SHEET: 7
JOB NUMBER: J-25803.0000 REVIEWED BY: SHG SCALE: AS SHOWN



682 Johnnie Dodds Blvd. • Suite 100
Mt. Pleasant, SC 29464 • 843.849.0200

www.thomasandhutton.com

REVISED: SEPT. 26, 2018



Z:\25803\25803.0000\Engineering\Drawings\permits\25803 - Riverwalk Permits.dwg - Sep 26, 2018 - 10:3:49 AM

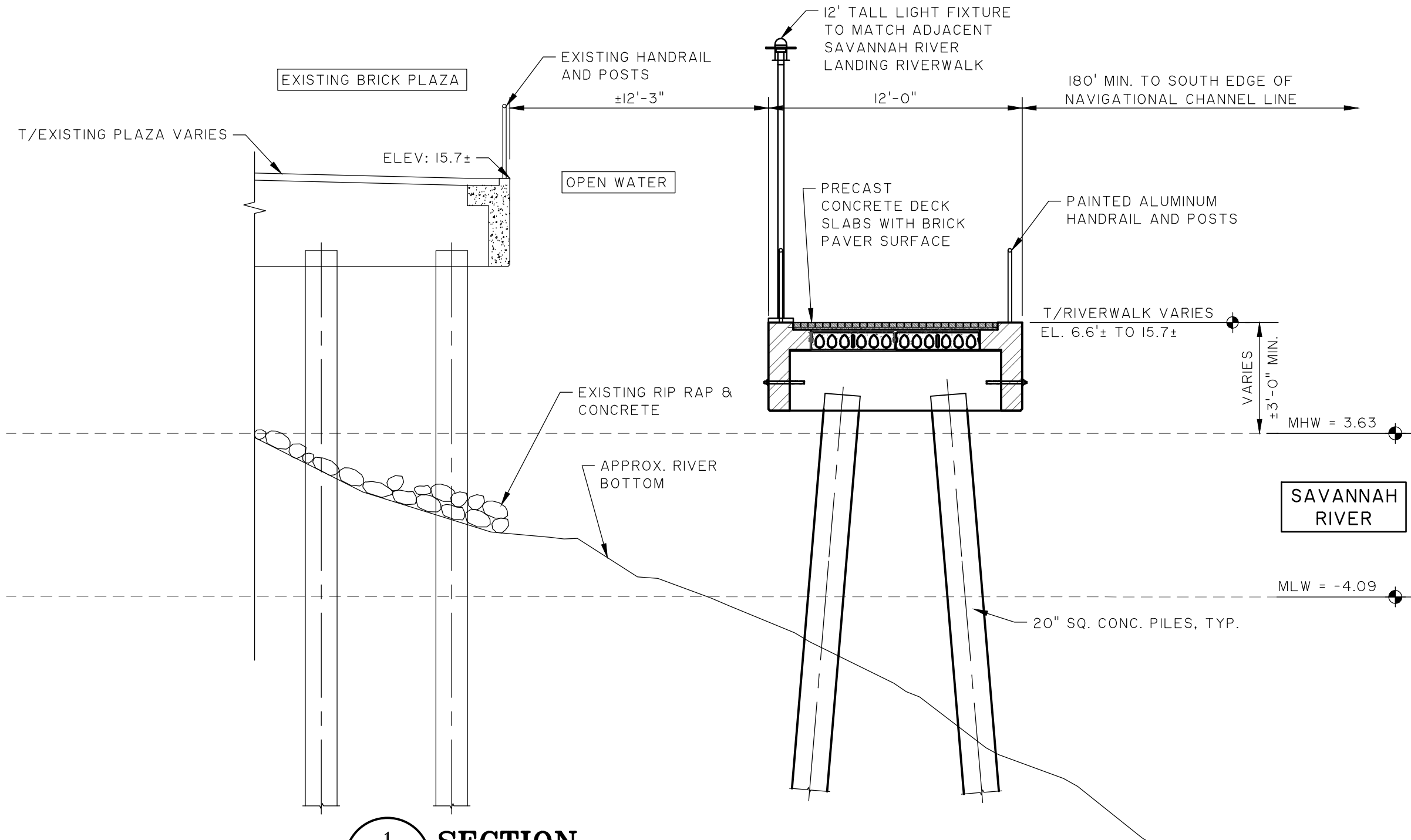

1 SECTION
8 SCALE: 3/16" = 1'-0"

RIVERWALK CONNECTION

SECTION AT 12'-0" WIDTH - WEST SIDE

CLIENT:
CITY OF SAVANNAH

LOCATION: SAVANNAH, GEORGIA
DATE: MAY 23, 2018 DRAWN BY: JWR SHEET: 8
JOB NUMBER: J-25803.0000 REVIEWED BY: SHG SCALE: AS SHOWN



682 Johnnie Dodds Blvd. • Suite 100
Mt. Pleasant, SC 29464 • 843.849.0200

www.thomasandhutton.com

DATUM: NAVD 88

NEW SHEET: SEPT. 26, 2018

