

CITY OF *Savannah* GEORGIA

EAST RIVER WALK CONNECTION



MAY 23, 2018
REVISED SEPTEMBER 26, 2018
J-25803.0000



RIVERWALK CONNECTION

CLIENT:
CITY OF SAVANNAH

LOCATION: SAVANNAH, GEORGIA

DATE: MAY 23, 2018

DRAWN BY: JWR

SHEET: 1

JOB NUMBER: J-25803.0000

REVIEWED BY: SHG

SCALE: As Shown

THOMAS & HUTTON
Engineering | Surveying | Planning | GIS | Consulting

50 Park of Commerce Way
Savannah, GA 31405 • 912.234.5300

www.thomasandhutton.com

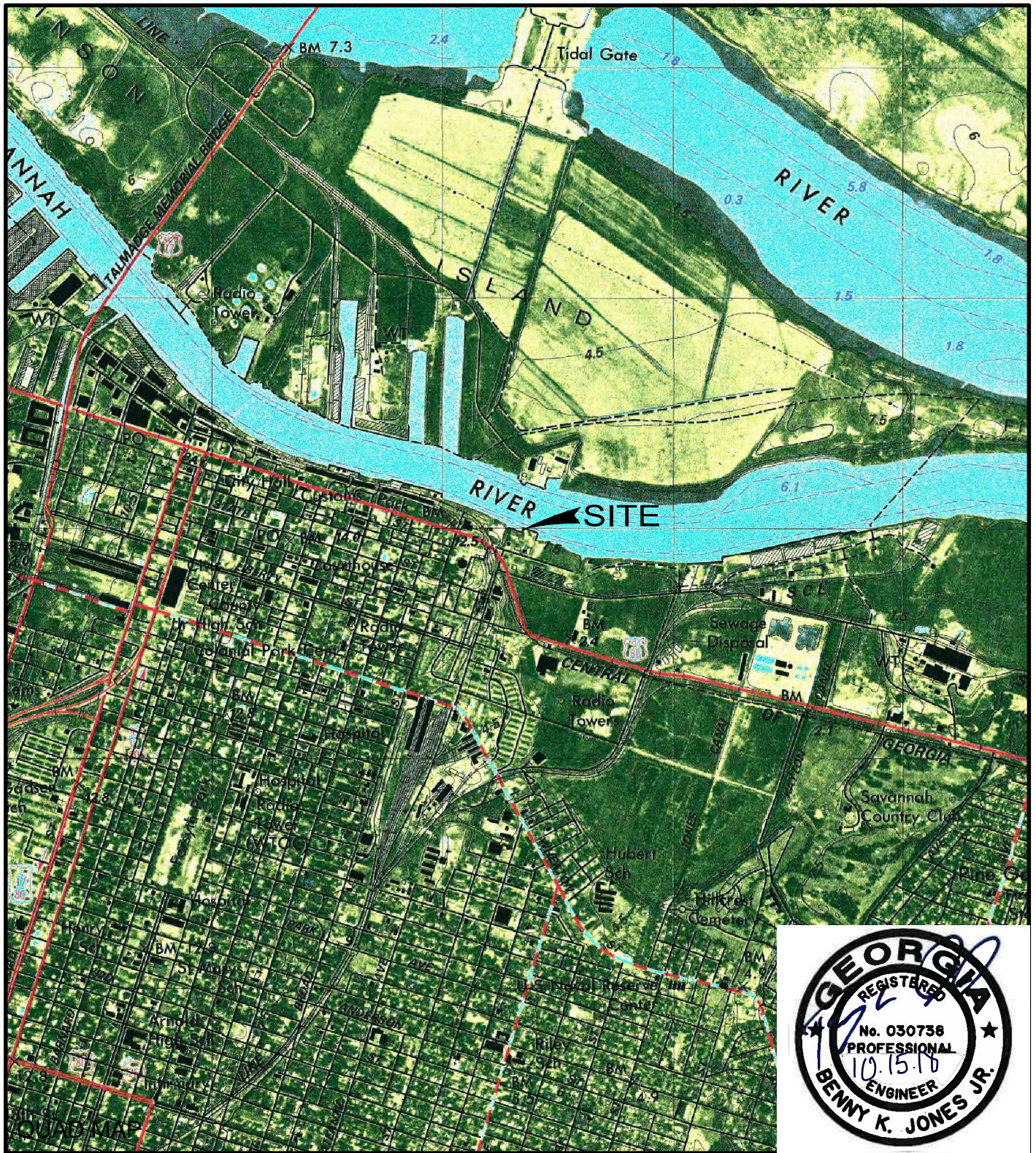

RIVERWALK CONNECTION

QUAD MAP

CLIENT:
CITY OF SAVANNAH

LOCATION: SAVANNAH, GEORGIA

DATE: MAY 23, 2018

DRAWN BY: JWR

SHEET: 2

JOB NUMBER: J-25803.0000

REVIEWED BY: SHG

SCALE: 1"=2000'



50 Park of Commerce Way
Savannah, GA 31405 • 912.234.5300

www.thomasandhutton.com

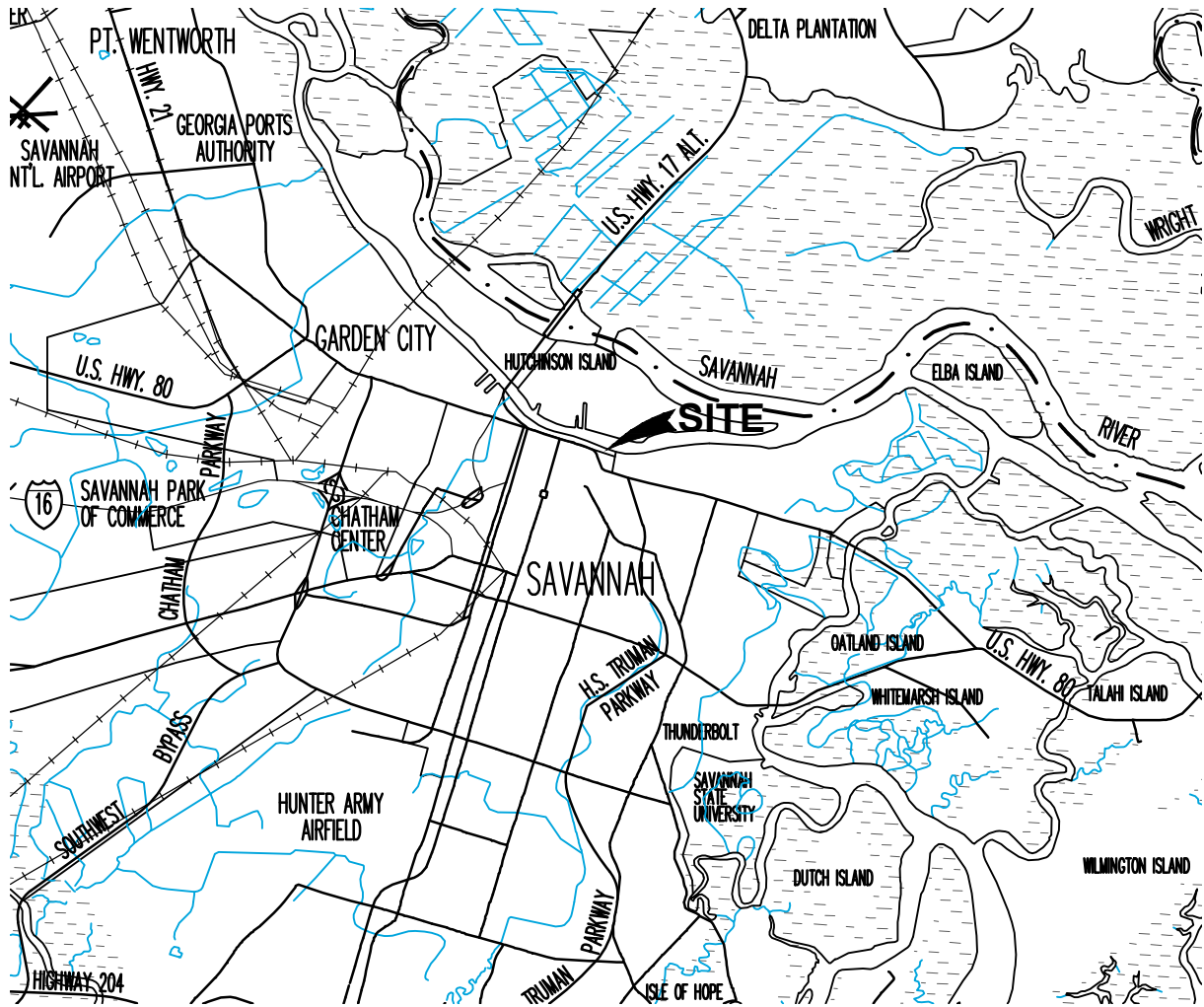

RIVERWALK CONNECTION

VICINITY MAP

CLIENT:

CITY OF SAVANNAH

LOCATION: SAVANNAH, GEORGIA

DATE: MAY 23, 2018

DRAWN BY: JWR

SHEET: 3

JOB NUMBER: J-25803.0000

REVIEWED BY: SHG

SCALE: 1" = 1000'



50 Park of Commerce Way
Savannah, GA 31405 • 912.234.5300

www.thomasandhutton.com

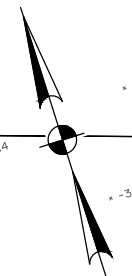
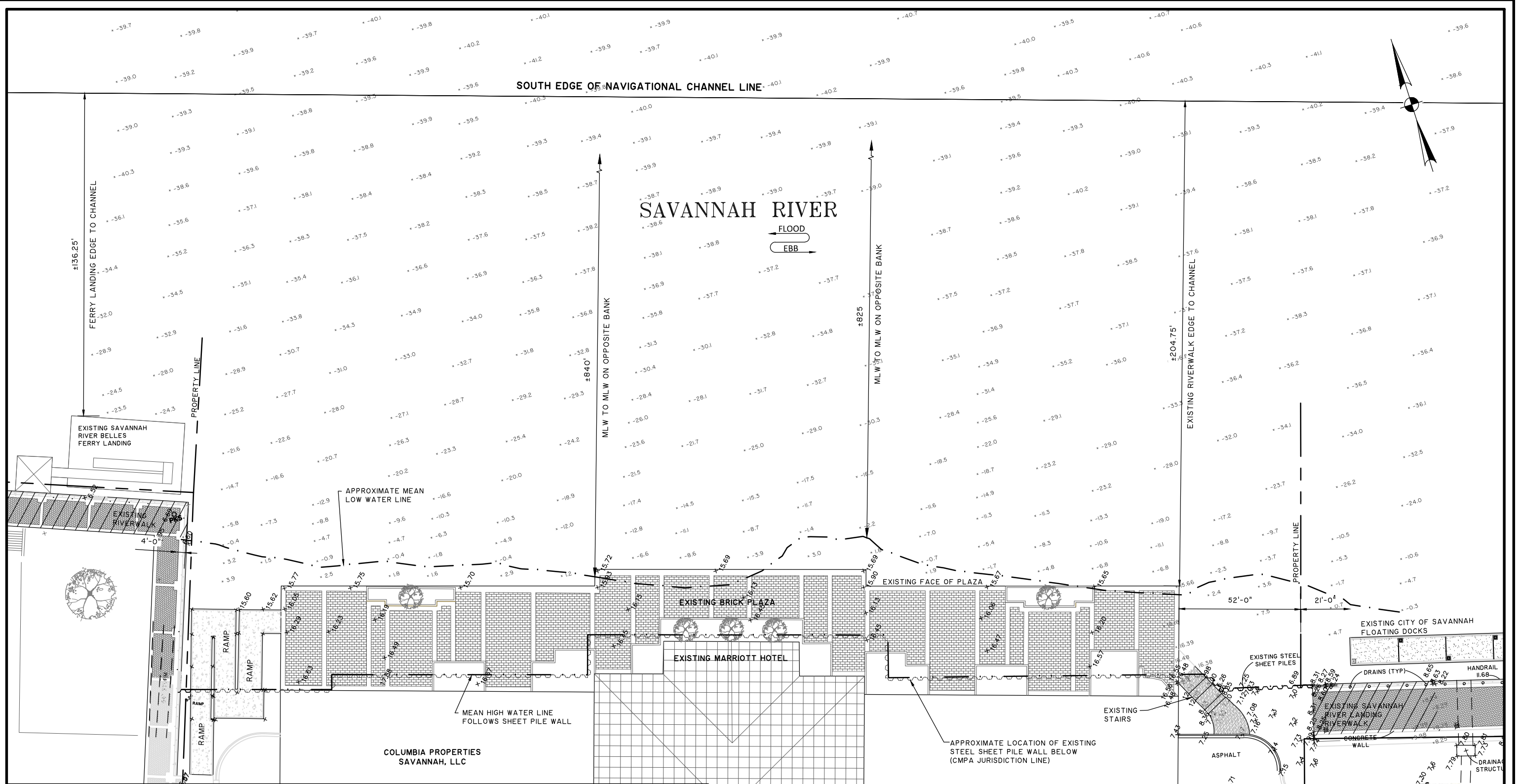

RIVERWALK CONNECTION

EXISTING CONDITIONS
 CLIENT: CITY OF SAVANNAH
 LOCATION: SAVANNAH, GEORGIA
 DATE: MAY 23, 2018
 JOB NUMBER: J-25803.0000

DRAWN BY: JWR
 REVIEWED BY: SHG

SHEET: 4
 SCALE: 1"=40'



50 Park of Commerce Way
 Savannah, GA 31405 • 912.234.5300

www.thomasandhutton.com

DATUM: NAVD 88

NOTES:
 1. HYDROGRAPHIC SURVEY BASED ON MLW DATUM.
 2. SURVEY PERFORMED ON OCTOBER 22, 2015.

REVISED: SEPT. 26, 2018



Z:\25803\25803.0000\Engineering\Drawings\permits\25803 - Riverwalk Permits.dwg - Sep 26, 2018 - 10:27:54 AM

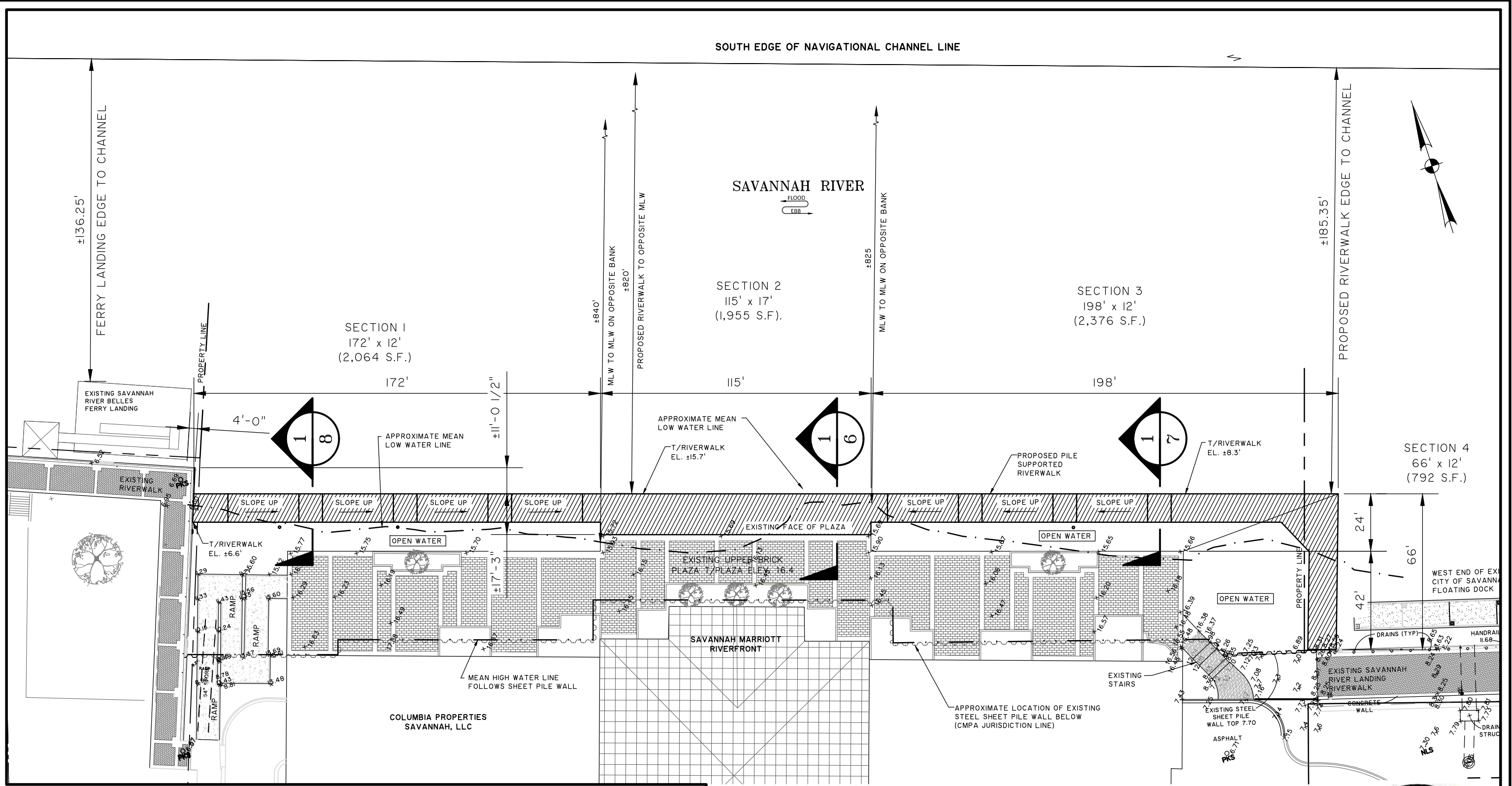

RIVERWALK CONNECTION

PROPOSED RIVERWALK PLAN

CLIENT:
CITY OF SAVANNAH
 LOCATION: SAVANNAH, GEORGIA
 DATE: MAY 23, 2018 DRAWN BY: JWR SHEET: 5
 JOB NUMBER: J-25803.0000 REVIEWED BY: SHG SCALE: 1"=40'



50 Park of Commerce Way
 Savannah, GA 31405 • 912.234.5300

www.thomasandhutton.com

DATUM: NAVD 88

ACREAGE SUMMARY		
SECTION 1 (172' x 12')	2,064 S.F.	(0.047 AC.)
SECTION 2 (115' x 17')	1,955 S.F.	(0.045 AC.)
SECTION 3 (198' x 12')	2,376 S.F.	(0.055 AC.)
SECTION 4 (66' x 12')	792 S.F.	(0.018 AC.)
TOTAL AREA:	7,187 S.F.	(0.165 AC.)

REVISED: SEPT. 26, 2018



Z:\25803\25803.0000\Engineering\Drawings\permits\25803 - Riverwalk Permits.dwg - Sep 26, 2018 - 10:3:49 AM

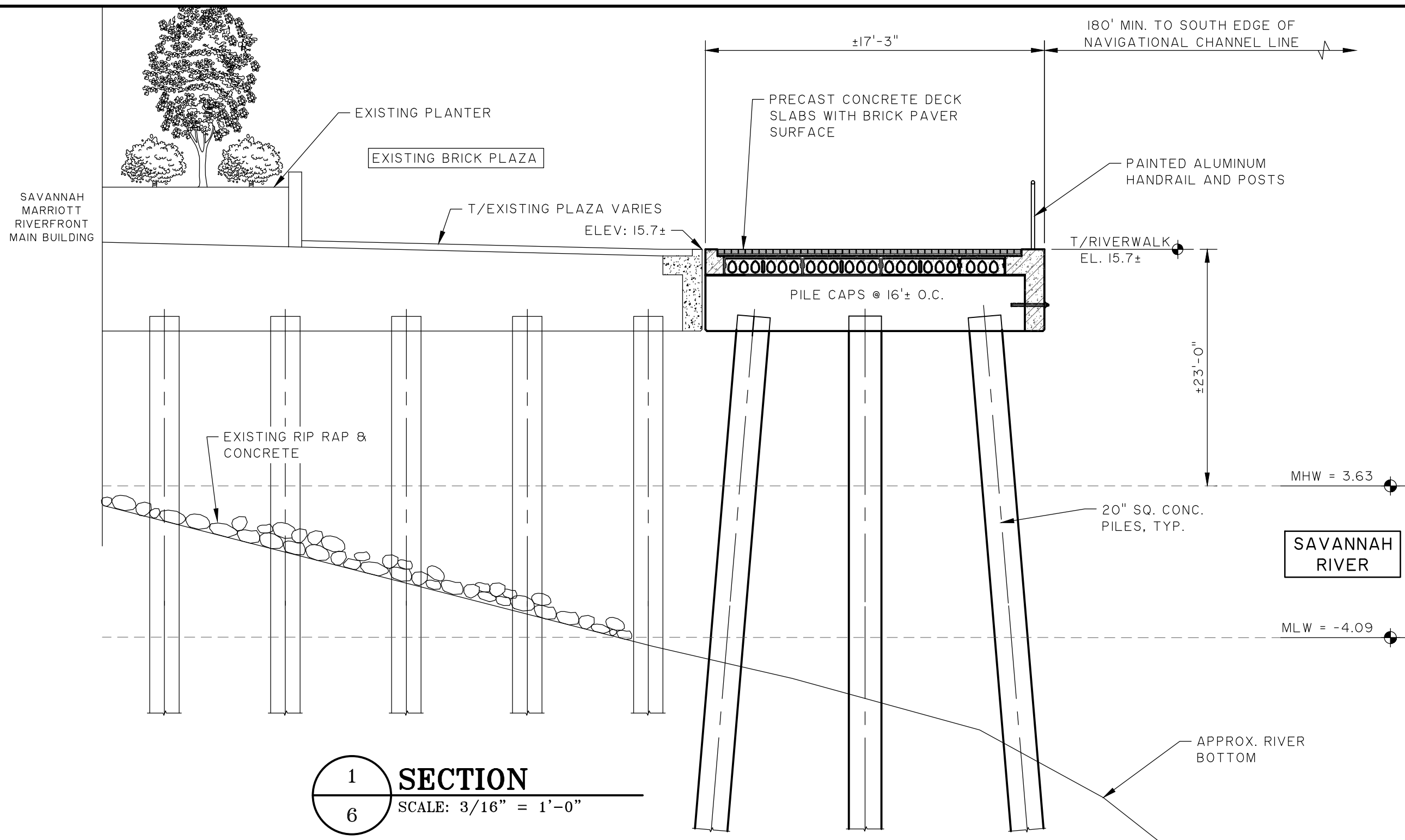

1 SECTION
6 SCALE: 3/16" = 1'-0"

RIVERWALK CONNECTION

SECTION AT EXISTING MARRIOTT PLAZA

CLIENT:
CITY OF SAVANNAH
LOCATION: SAVANNAH, GEORGIA
DATE: MAY 23, 2018 DRAWN BY: JWR SHEET: 6
JOB NUMBER: J-25803.0000 REVIEWED BY: SHG SCALE: AS SHOWN



50 Park of Commerce Way
Savannah, GA 31405 • 912.234.5300

www.thomasandhutton.com

DATUM: NAVD 88

REVISED: SEPT. 26, 2018



Z:\25803\25803.0000\Engineering\Drawings\permits\25803 - Riverwalk Permits.dwg - Sep 26, 2018 - 10:3:49 AM

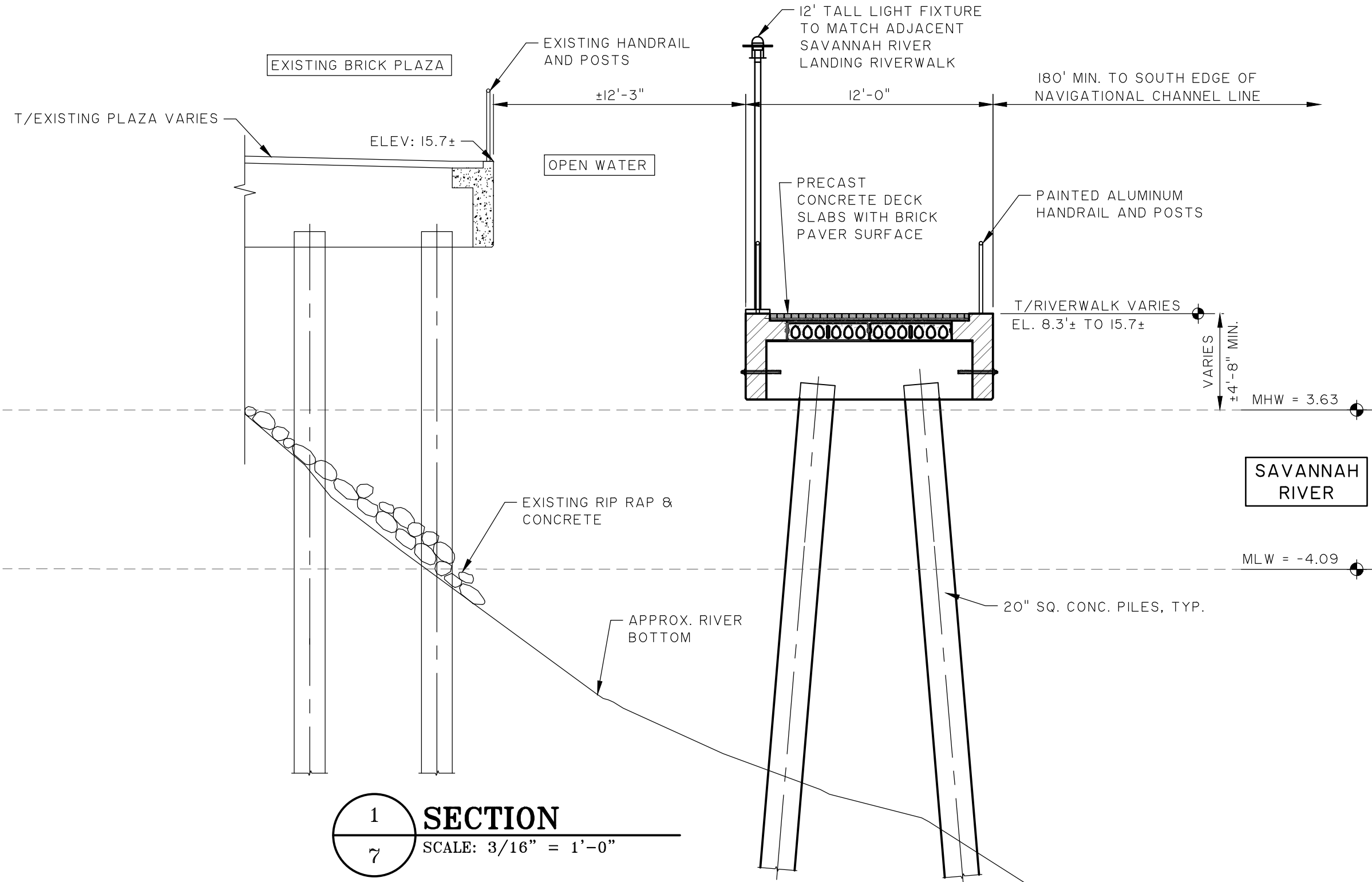

1 SECTION
 7 SCALE: 3/16" = 1'-0"

DATUM: NAVD 88

RIVERWALK CONNECTION

SECTION AT 12'-0" WIDTH - EAST SIDE

CLIENT:
 CITY OF SAVANNAH
 LOCATION: SAVANNAH, GEORGIA
 DATE: MAY 23, 2018 DRAWN BY: JWR SHEET: 7
 JOB NUMBER: J-25803.0000 REVIEWED BY: SHG SCALE: AS SHOWN



682 Johnnie Dodds Blvd. • Suite 100
 Mt. Pleasant, SC 29464 • 843.849.0200

www.thomasandhutton.com

REVISED: SEPT. 26, 2018



Z:\25803\25803.0000\Engineering\Drawings\permits\25803 - Riverwalk Permits.dwg - Sep 26, 2018 - 10:3:49 AM

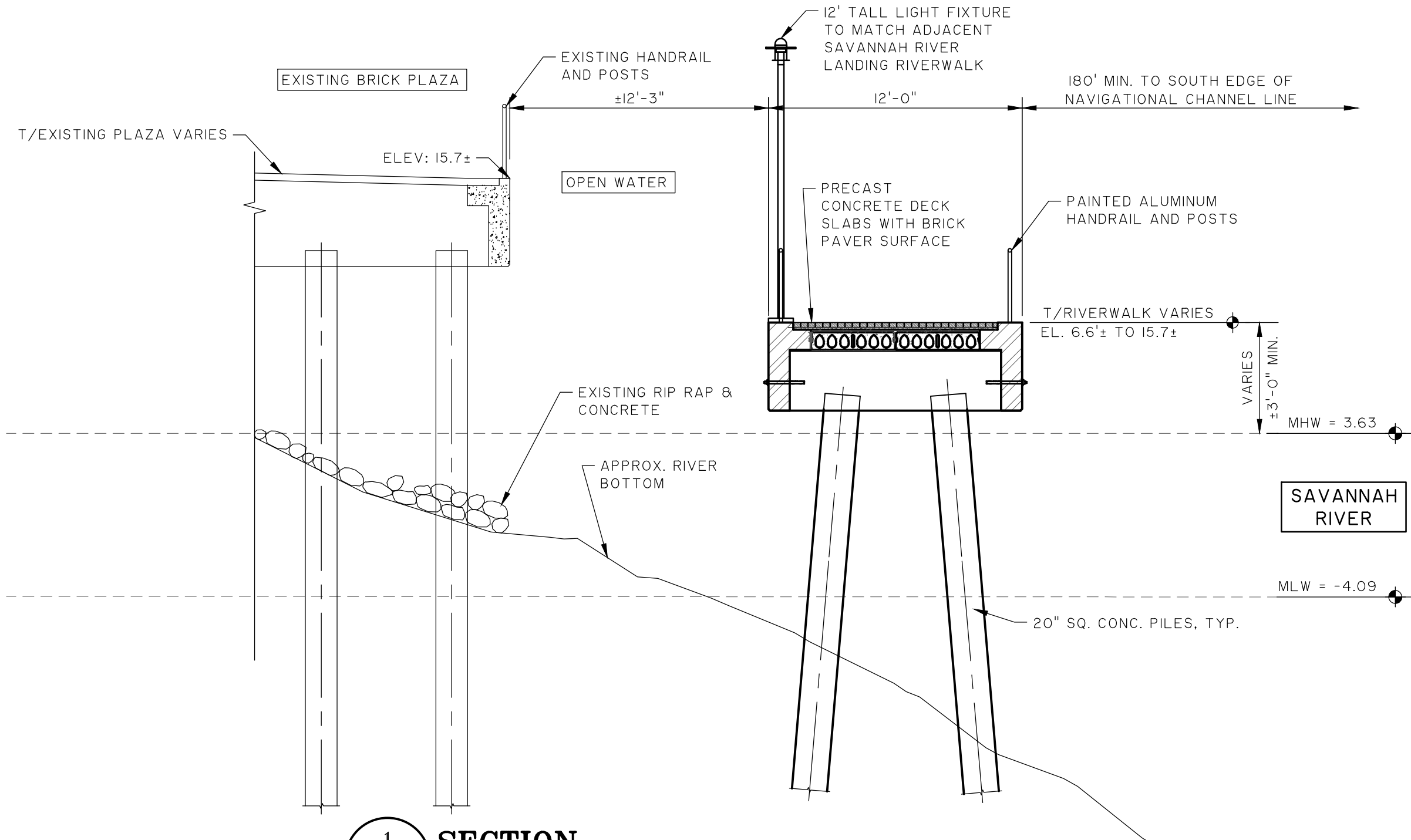

1 SECTION
8 SCALE: 3/16" = 1'-0"

RIVERWALK CONNECTION

SECTION AT 12'-0" WIDTH - WEST SIDE

CLIENT:
CITY OF SAVANNAH

LOCATION: SAVANNAH, GEORGIA
DATE: MAY 23, 2018 DRAWN BY: JWR SHEET: 8
JOB NUMBER: J-25803.0000 REVIEWED BY: SHG SCALE: AS SHOWN



682 Johnnie Dodds Blvd. • Suite 100
Mt. Pleasant, SC 29464 • 843.849.0200

www.thomasandhutton.com

DATUM: NAVD 88

NEW SHEET: SEPT. 26, 2018

