

MATCHLINE - SEE SHEET 4

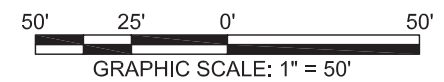

SHEET 3

EMC ENGINEERING SERVICES, INC.
 10 Chatham Center South,
 Ste 100
 Savannah, GA 31405
 Ph: (912) 232-6533
 Fax: (912) 233-4580
 savannah@emc-eng.com
 www.emc-eng.com

ALBANY, ATLANTA, AUGUSTA, BRUNSWICK,
 COLUMBUS, STATESBORO & VALDOSTA

OVERALL EXISTING CONDITIONS
SAVANNAH BOATHOUSE DEVELOPMENT
 8020 E. US HWY 80
 CHATHAM COUNTY, GEORGIA
 Prepared for:
3 SEA SONS, LLC.

PROJECT NO:	18-0143
DRAWN BY:	TCB
DESIGNED BY:	TCB
SURVEYED BY:	YAWN
SURVEY DATE:	JAN. 2019
CHECKED BY:	JMM
SCALE:	1" = 50'
DATE:	MAY 30, 2019

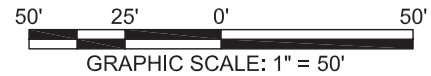
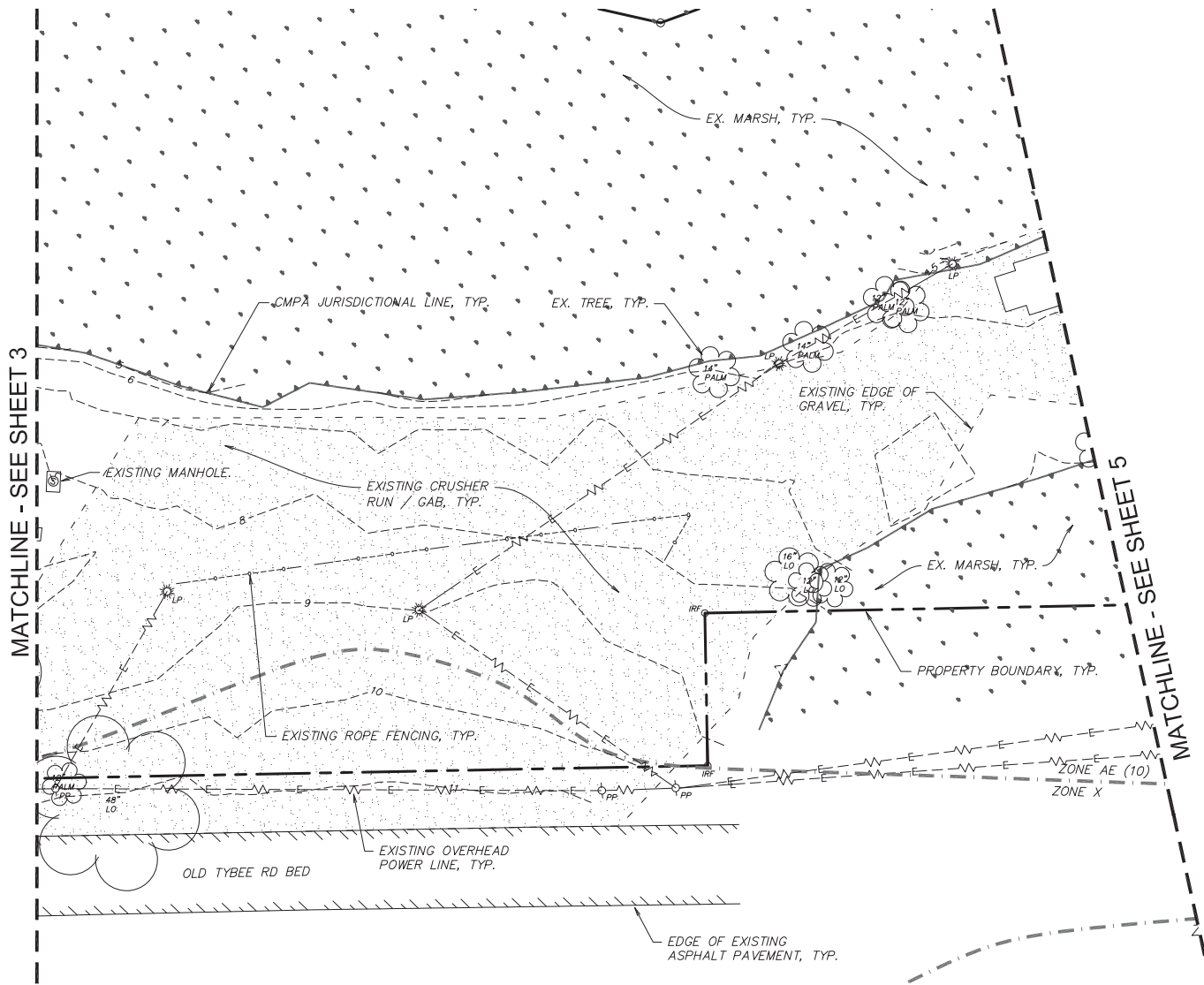

SHEET 4

EMC ENGINEERING SERVICES, INC.
 10 Chatham Center South,
 Ste 100
 Savannah, GA 31405
 Ph: (912) 232-6533
 Fax: (912) 233-4580
 savannah@emc-eng.com
 www.emc-eng.com

ALBANY, ATLANTA, AUGUSTA, BRUNSWICK,
 COLUMBUS, STATESBORO & VALDOSTA

OVERALL EXISTING CONDITIONS
SAVANNAH BOATHOUSE DEVELOPMENT
 8020 E. US HWY 80
 CHATHAM COUNTY, GEORGIA
 Prepared for:
 3 SEA SONS, LLC.

PROJECT NO: 18-0143
 DRAWN BY: TCB
 DESIGNED BY: TCB
 SURVEYED BY: YAWN
 SURVEY DATE: JAN. 2019
 CHECKED BY: JMM
 SCALE: 1" = 50'
 DATE: MAY 30, 2019



SHEET 5

EMC ENGINEERING SERVICES, INC.
 10 Chatham Center South,
 Ste 100
 Savannah, GA 31405
 Ph: (912) 232-6533
 Fax: (912) 233-4580
 savannah@emc-eng.com
 www.emc-eng.com

ALBANY, ATLANTA, AUGUSTA, BRUNSWICK,
 COLUMBUS, STATESBORO & VALDOSTA

OVERALL EXISTING CONDITIONS
SAVANNAH BOATHOUSE DEVELOPMENT
 8020 E. US HWY 80
 CHATHAM COUNTY, GEORGIA
 Prepared for:
 3 SEA SONS, LLC.

PROJECT NO:	18-0143
DRAWN BY:	TCB
DESIGNED BY:	TCB
SURVEYED BY:	YAWN
SURVEY DATE:	JAN. 2019
CHECKED BY:	JMM
SCALE:	1" = 50'
DATE:	MAY 30, 2019

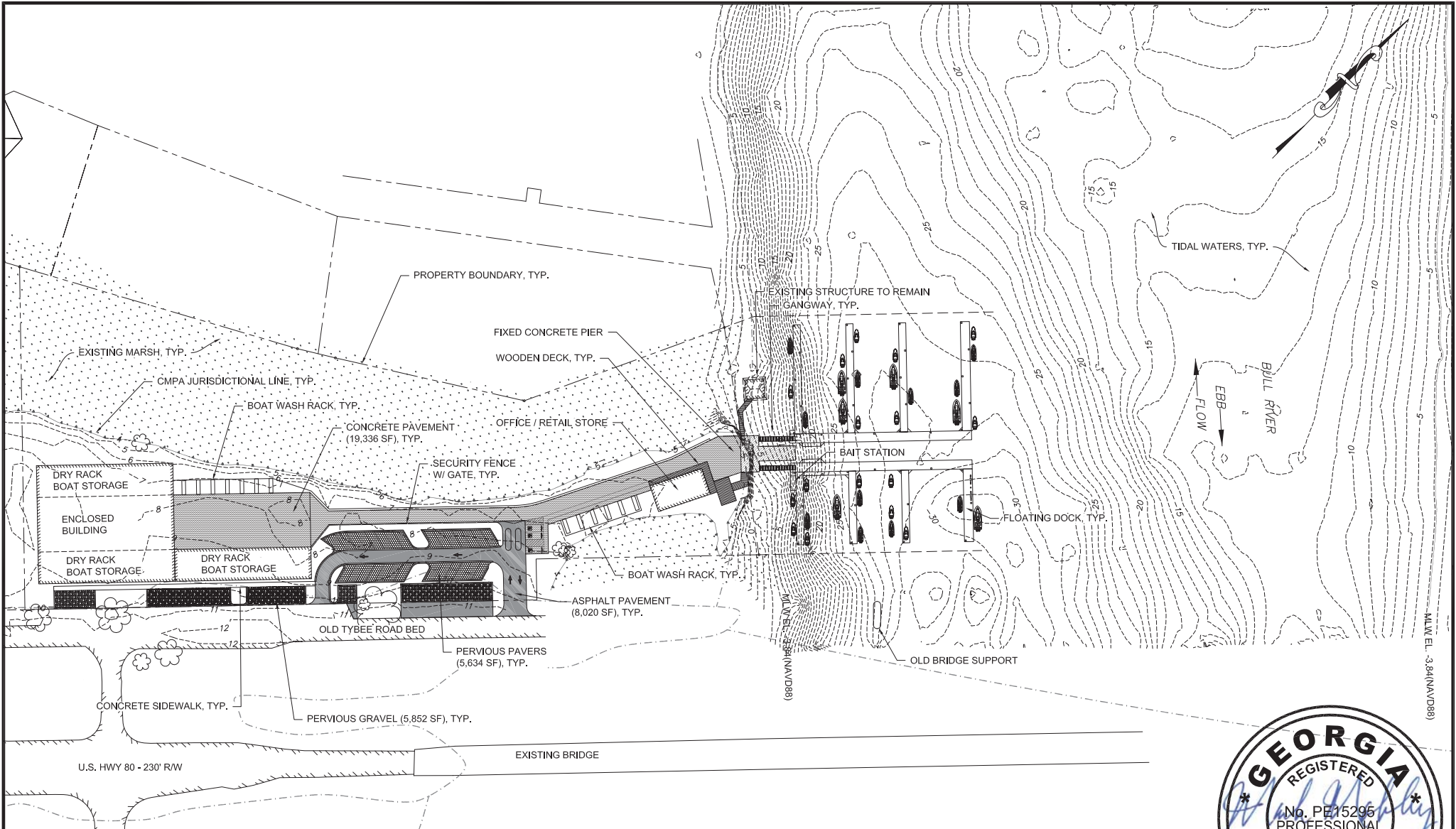

MLW EL. -3.84 (NAD83)

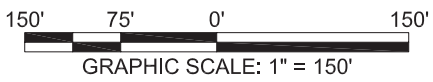

SHEET 6

EMC ENGINEERING SERVICES, INC.
 10 Chatham Center South,
 Ste 100
 Savannah, GA 31405
 Ph: (912) 232-6533
 Fax: (912) 233-4580
 savannah@emc-eng.com
 www.emc-eng.com

emc CIVIL MARINE ENVIRONMENTAL

ALBANY, ATLANTA, AUGUSTA, BRUNSWICK,
 COLUMBUS, STATESBORO & VALDOSTA

OVERALL PROPOSED IMPROVEMENTS
SAVANNAH BOATHOUSE DEVELOPMENT
 8020 E. US HWY 80
 CHATHAM COUNTY, GEORGIA
 Prepared for:
3 SEA SONS, LLC.

PROJECT NO: 18-0143
 DRAWN BY: TCB
 DESIGNED BY: TCB
 SURVEYED BY: YAWN
 SURVEY DATE: JAN. 2019
 CHECKED BY: JMM
 SCALE: 1" = 150'
 DATE: MAY 30, 2019

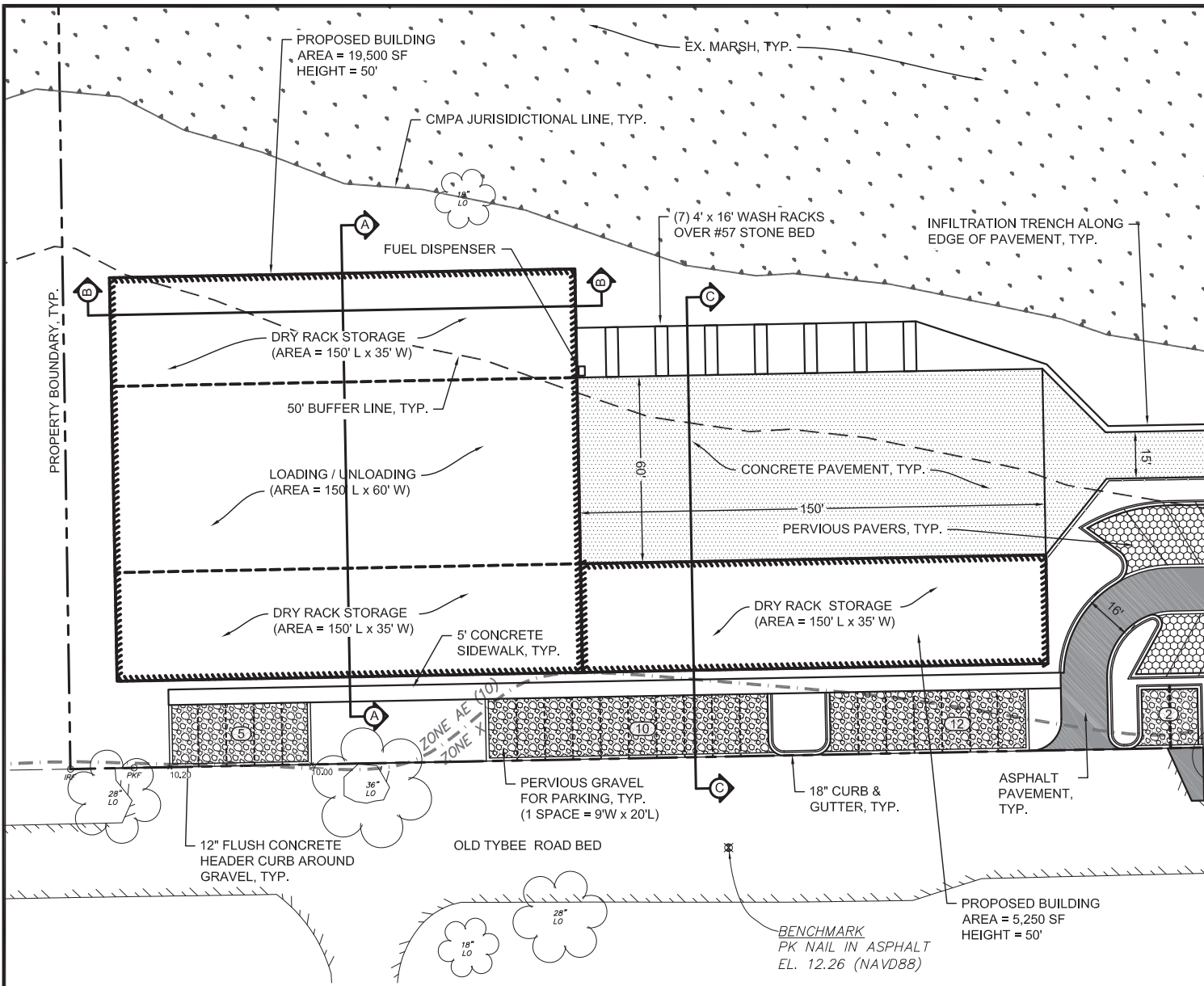

MATCHLINE - SEE SHEET 8

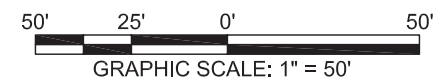
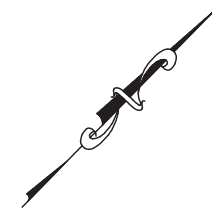

SHEET 7

EMC ENGINEERING SERVICES, INC.
 10 Chatham Center South,
 Ste 100
 Savannah, GA 31405
 Ph: (912) 232-6533
 Fax: (912) 233-4580
 savannah@emc-eng.com
 www.emc-eng.com

emc CIVIL MARINE ENVIRONMENTAL

ALBANY, ATLANTA, AUGUSTA, BRUNSWICK,
 COLUMBUS, STATESBORO & VALDOSTA

PROPOSED IMPROVEMENTS

SAVANNAH BOATHOUSE DEVELOPMENT

8020 E. US HWY 80
 CHATHAM COUNTY, GEORGIA

Prepared for:
3 SEA SONS, LLC.

PROJECT NO:	18-0143
DRAWN BY:	TCB
DESIGNED BY:	TCB
SURVEYED BY:	YAWN
SURVEY DATE:	JAN. 2019
CHECKED BY:	JMM
SCALE:	1" = 50'
DATE:	MAY 30, 2019

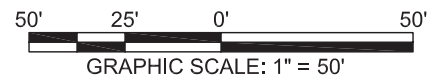
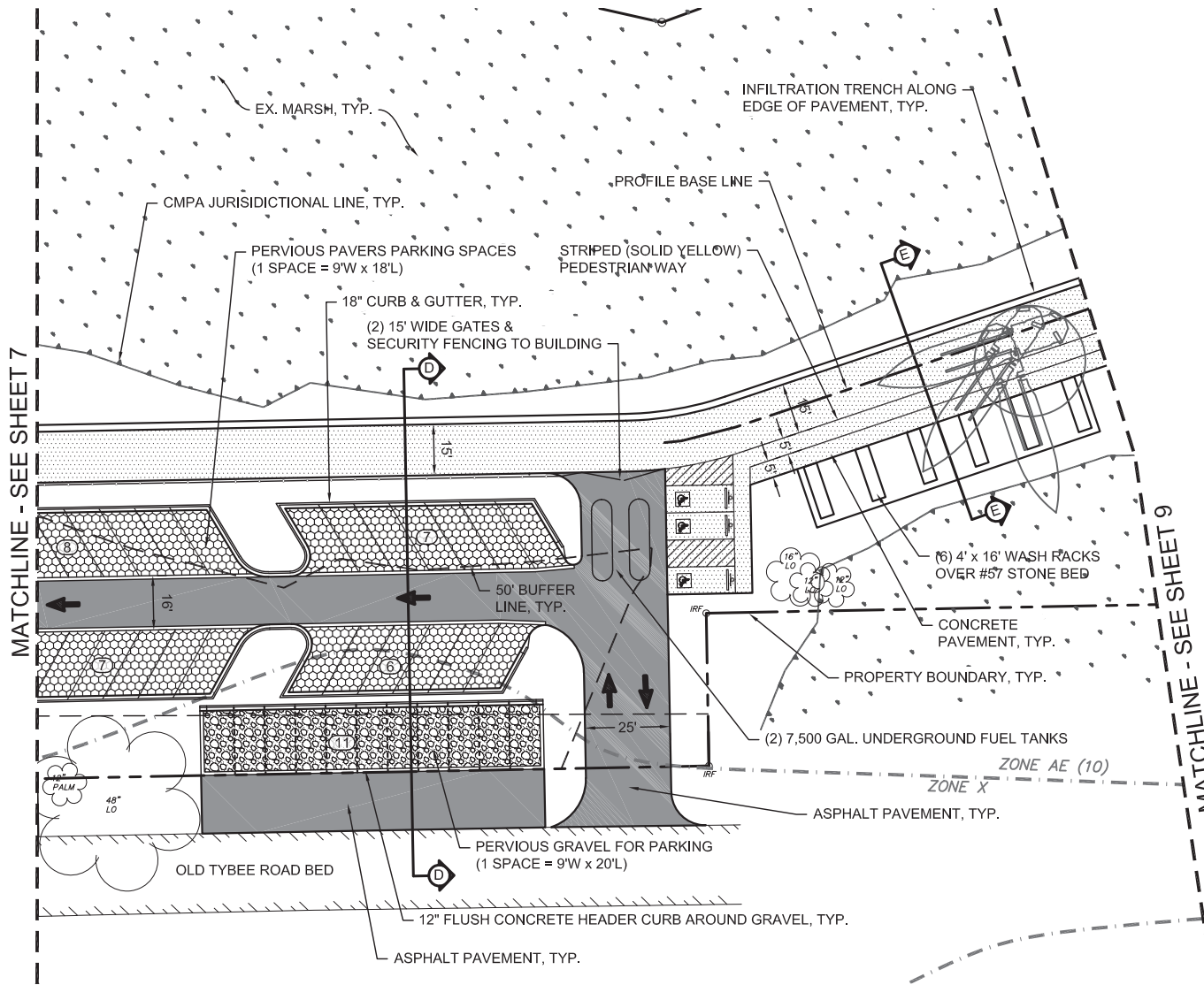

SHEET 8

EMC ENGINEERING SERVICES, INC.
 10 Chatham Center South,
 Ste 100
 Savannah, GA 31405
 Ph: (912) 232-6533
 Fax: (912) 233-4580
 savannah@emc-eng.com
 www.emc-eng.com

emc CIVIL MARINE ENVIRONMENTAL

ALBANY, ATLANTA, AUGUSTA, BRUNSWICK,
 COLUMBUS, STATESBORO & VALDOSTA

PROPOSED IMPROVEMENTS

SAVANNAH BOATHOUSE DEVELOPMENT

8020 E. US HWY 80
 CHATHAM COUNTY, GEORGIA

Prepared for:
 3 SEA SONS, LLC.

PROJECT NO:	18-0143
DRAWN BY:	TCB
DESIGNED BY:	TCB
SURVEYED BY:	YAWN
SURVEY DATE:	JAN. 2019
CHECKED BY:	JMM
SCALE:	1" = 50'
DATE:	MAY 30, 2019

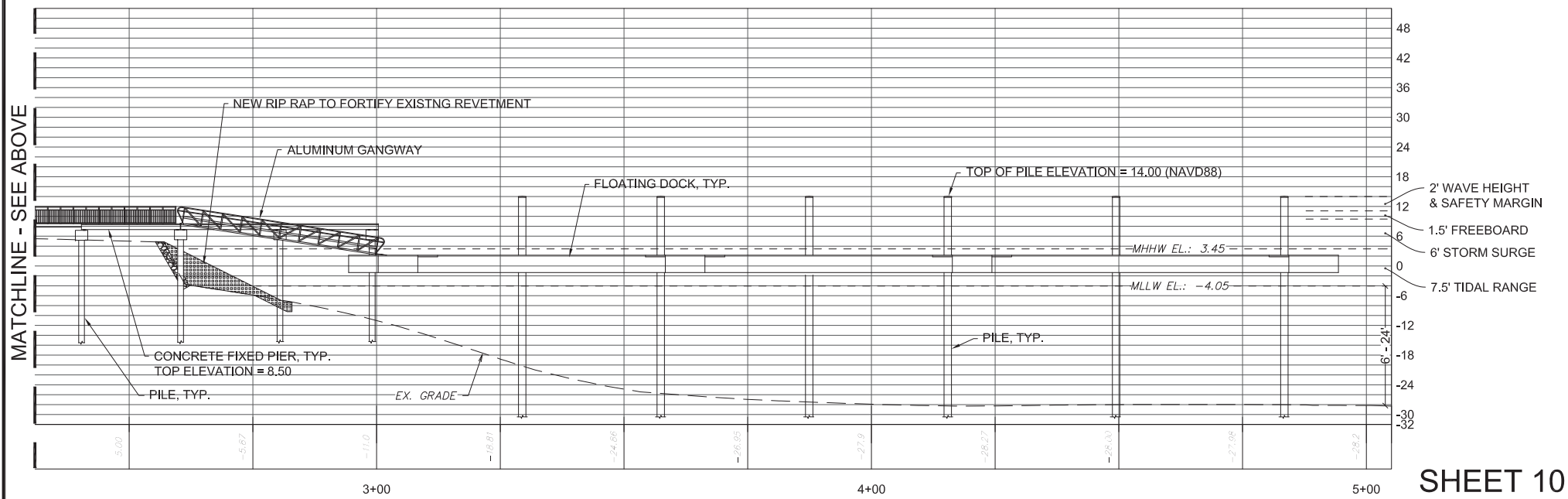
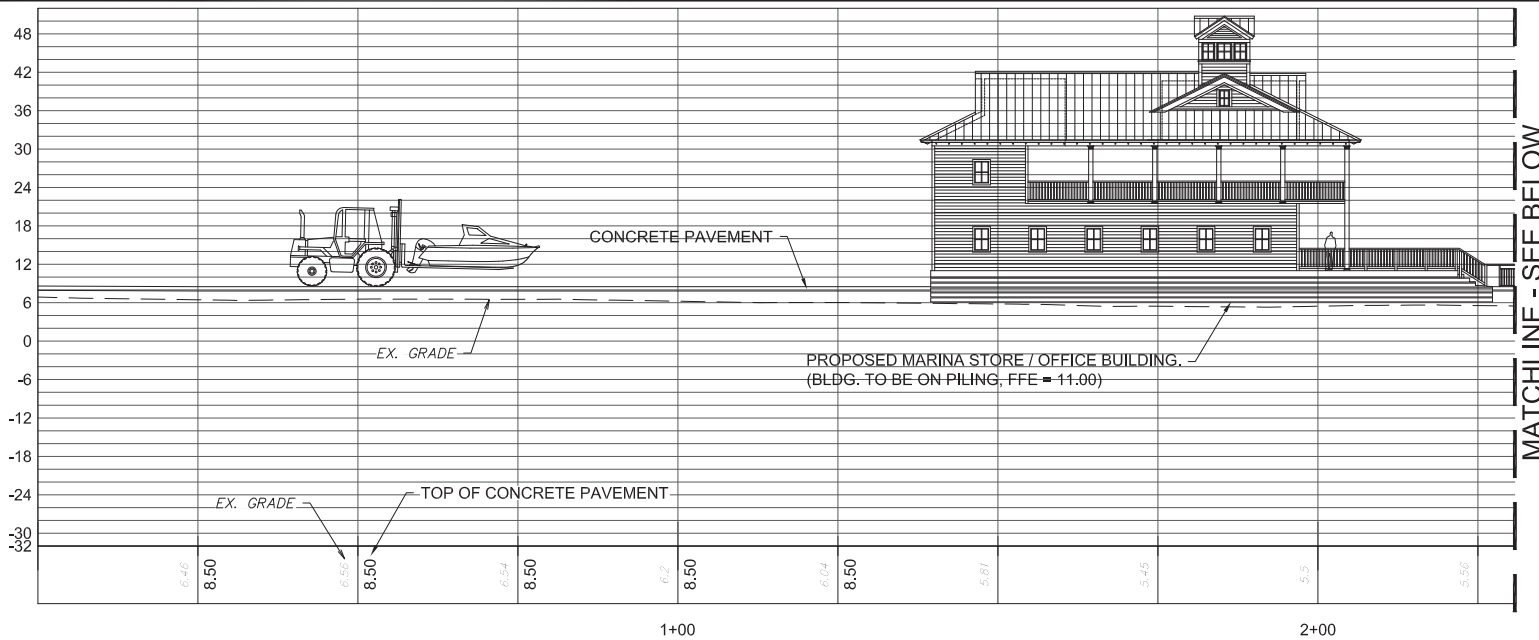

SHEET 10

EMC ENGINEERING SERVICES, INC.
 10 Chatham Center South,
 Ste 100
 Savannah, GA 31405
 Ph: (912) 232-6533
 Fax: (912) 233-4580
 savannah@emc-eng.com
 www.emc-eng.com

CIVIL MARINE ENVIRONMENTAL

ALBANY, ATLANTA, AUGUSTA, BRUNSWICK,
 COLUMBUS, STATESBORO & VALDOSTA

FORKLIFT PATH, FIXED PIER, & FLOATING DOCK PROFILE

SAVANNAH BOATHOUSE DEVELOPMENT

8020 E. US HWY 80
 CHATHAM COUNTY, GEORGIA

Prepared for:
3 SEA SONS, LLC.

PROJECT NO:	18-0143
DRAWN BY:	TCB
DESIGNED BY:	TCB
SURVEYED BY:	YAWN
SURVEY DATE:	JAN. 2019
CHECKED BY:	JMM
SCALE:	1" = 30'
DATE:	MAY 30, 2019

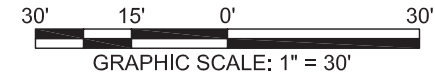
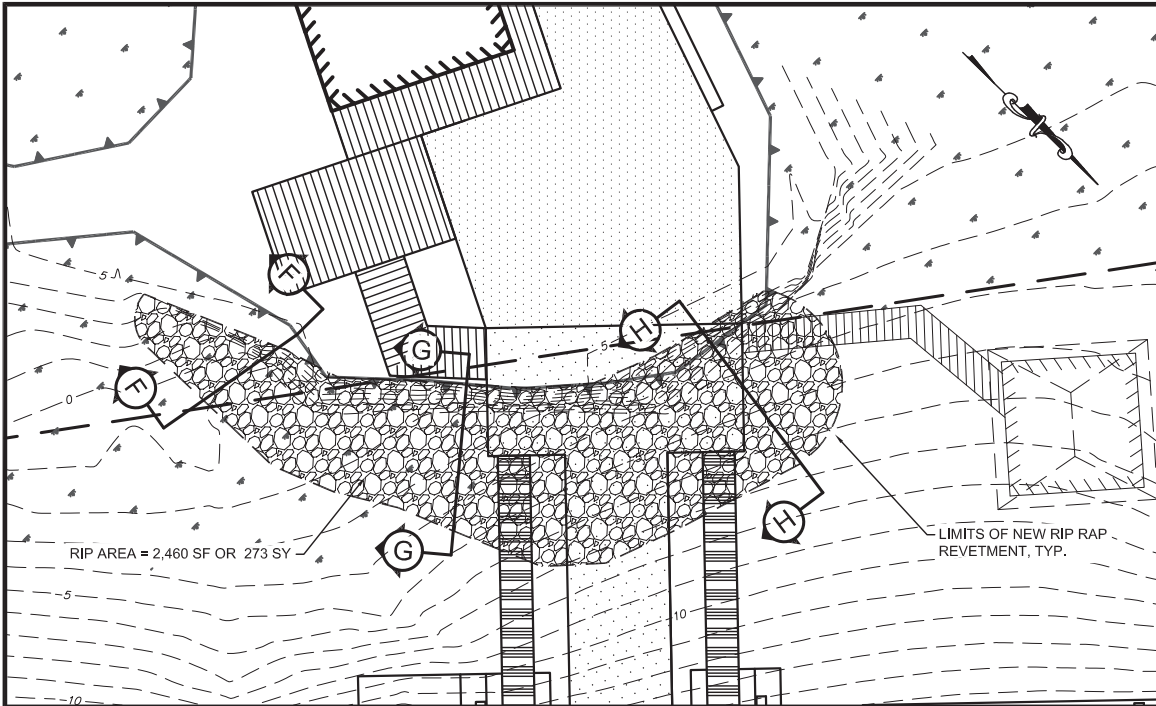

NOTES:

1. RIP RAP TO BE TYPE 2 AND MEET THE REQUIREMENTS OF GDOT STD. 805.
2. FILTER FABRIC TO BE PLACED UNDER RIP RAP AND SHOULD BE MIRAFLI HP570 OR APPROVED EQUAL.

PLAN
SCALE: 1" = 30'

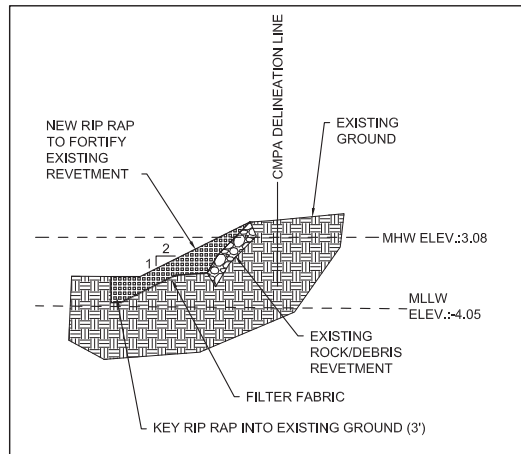

SECTION F-F

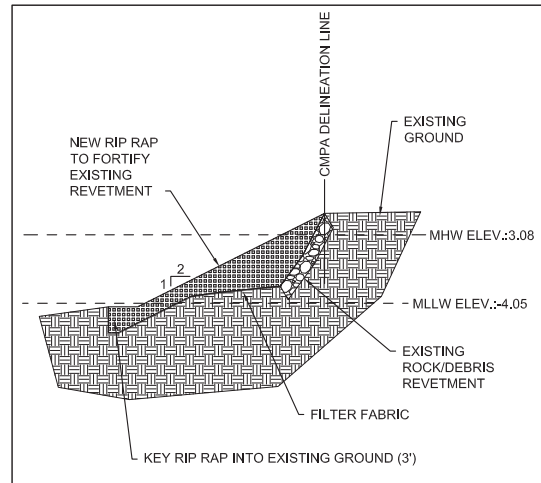

SECTION G-G

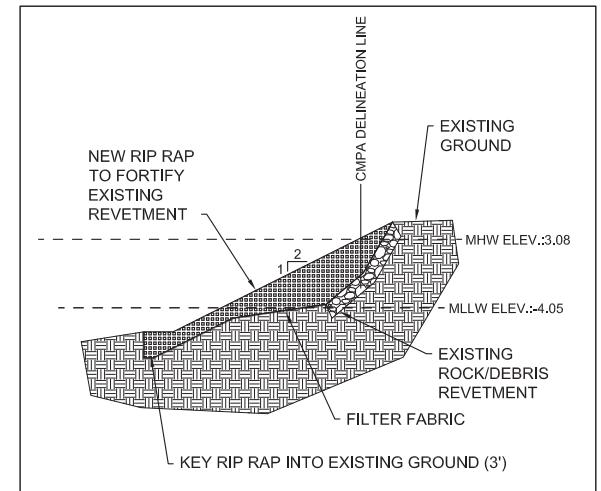

SECTION H-H

SHEET 11

EMC ENGINEERING SERVICES, INC.

10 Chatham Center South,
Ste 100
Savannah, GA 31405
Ph: (912) 232-6533
Fax: (912) 233-4580
savannah@emc-eng.com
www.emc-eng.com

ALBANY, ATLANTA, AUGUSTA, BRUNSWICK,
COLUMBUS, STATESBORO & VALDOSTA



RIP RAP REVETMENT PLAN AND DETAIL

SAVANNAH BOATHOUSE DEVELOPMENT

8020 E. US HWY 80
CHATHAM COUNTY, GEORGIA

Prepared for:
3 SEA SONS, LLC.

PROJECT NO:	18-0143
DRAWN BY:	TCB
DESIGNED BY:	TCB
SURVEYED BY:	YAWN
SURVEY DATE:	JAN. 2019
CHECKED BY:	JMM
SCALE:	1" = 30'
DATE:	MAY 30, 2019

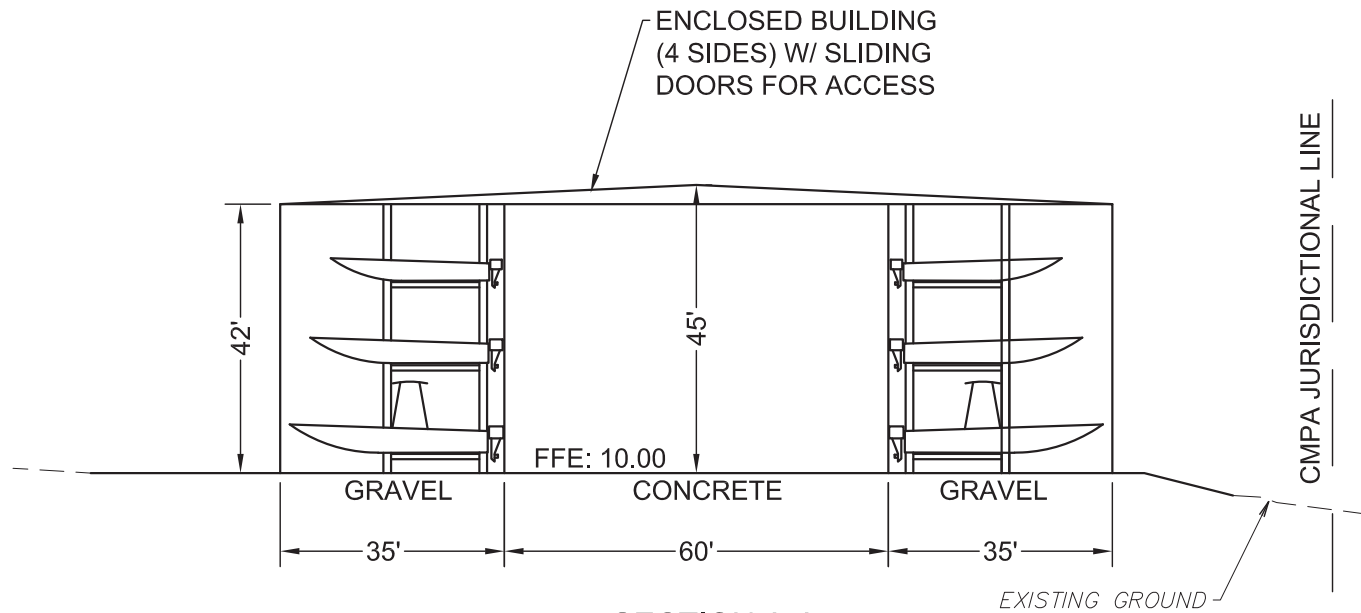

SECTION A-A
SCALE: 1" = 30'

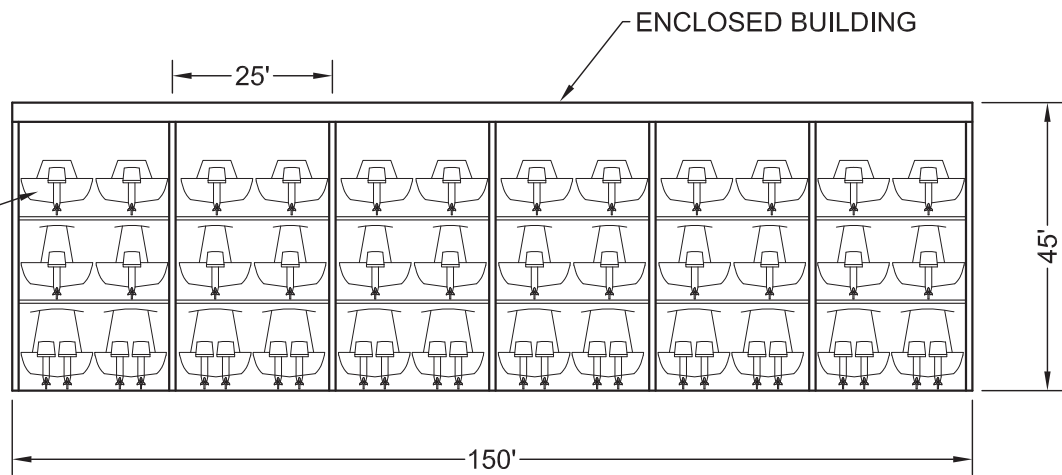

SECTION B-B
SCALE: 1" = 30'

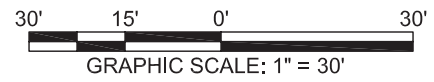

SHEET 12

EMC ENGINEERING SERVICES, INC.
 10 Chatham Center South,
 Ste 100
 Savannah, GA 31405
 Ph: (912) 232-6533
 Fax: (912) 233-4580
 savannah@emc-eng.com
 www.emc-eng.com

ALBANY, ATLANTA, AUGUSTA, BRUNSWICK,
 COLUMBUS, STATESBORO & VALDOSTA

CROSS SECTIONS

SAVANNAH BOATHOUSE DEVELOPMENT

8020 E. US HWY 80
 CHATHAM COUNTY, GEORGIA

Prepared for:
3 SEA SONS, LLC.

PROJECT NO:	18-0143
DRAWN BY:	TCB
DESIGNED BY:	TCB
SURVEYED BY:	YAWN
SURVEY DATE:	JAN. 2019
CHECKED BY:	JMM
SCALE:	1" = 30'
DATE:	MAY 30, 2019

ENCLOSED (3 SIDES ONLY)

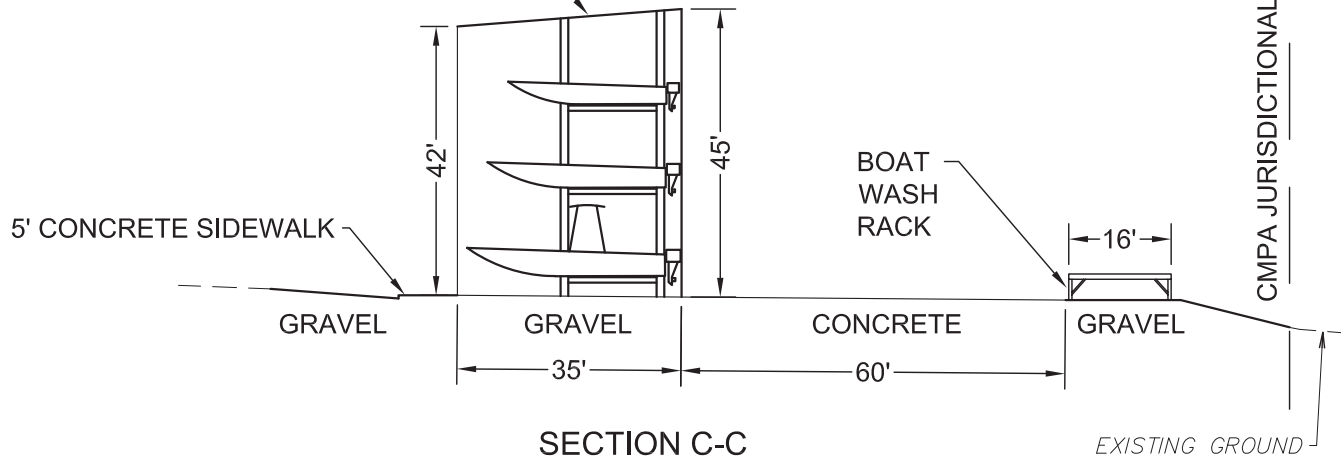

SECTION C-C
SCALE: 1" = 30'

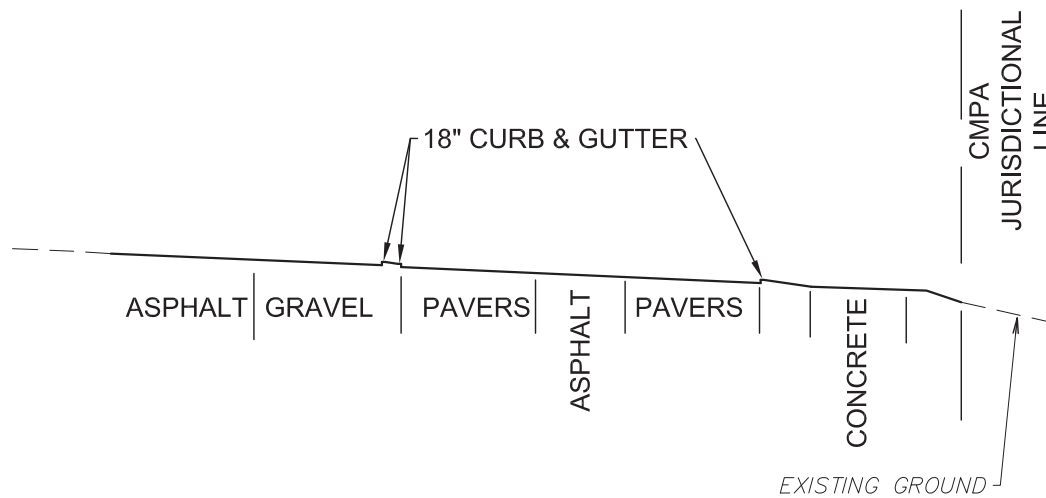
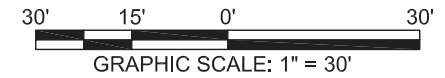

SECTION D-D
SCALE: 1" = 30'

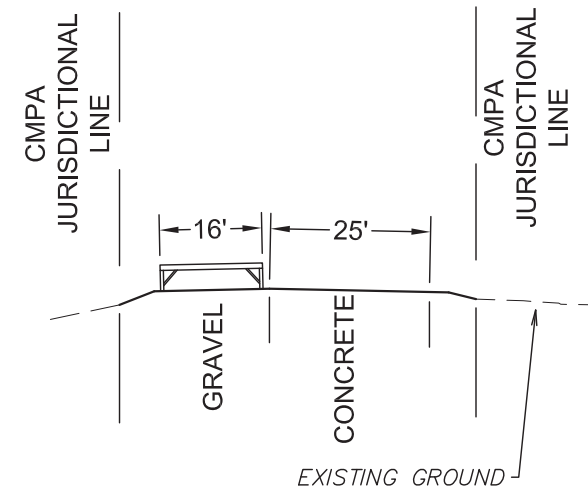

SECTION E-E
SCALE: 1" = 30'

SHEET 13

EMC ENGINEERING SERVICES, INC.
10 Chatham Center South,
Ste 100
Savannah, GA 31405
Ph: (912) 232-6533
Fax: (912) 233-4580
savannah@emc-eng.com
www.emc-eng.com

ALBANY, ATLANTA, AUGUSTA, BRUNSWICK,
COLUMBUS, STATESBORO & VALDOSTA

CROSS SECTIONS

SAVANNAH BOATHOUSE DEVELOPMENT

8020 E. US HWY 80
CHATHAM COUNTY, GEORGIA

Prepared for:
3 SEA SONS, LLC.

PROJECT NO: 18-0143
DRAWN BY: TCB
DESIGNED BY: TCB
SURVEYED BY: YAWN
SURVEY DATE: JAN. 2019
CHECKED BY: JMM
SCALE: 1" = 30'
DATE: MAY 30, 2019



**8' DOCK
TYPICAL SECTION**
SCALE: 1" = 2'

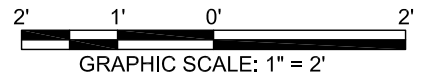
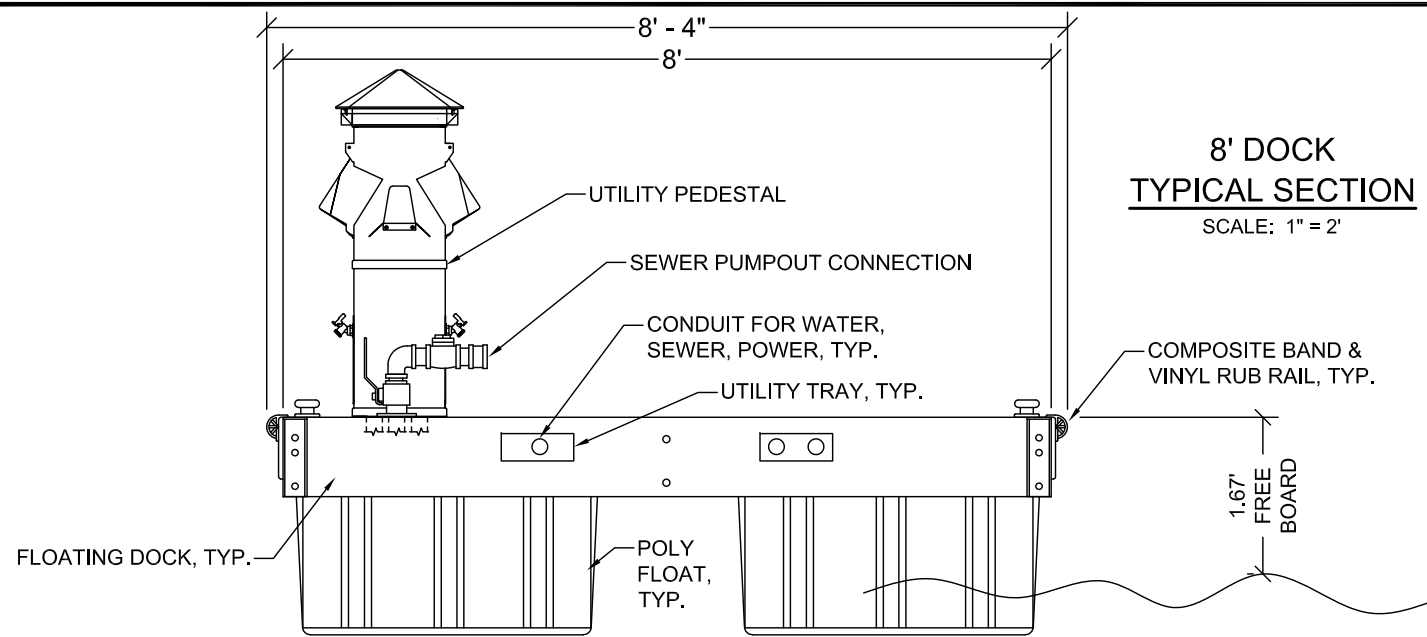

**10' DOCK
TYPICAL SECTION**
SCALE: 1" = 2'

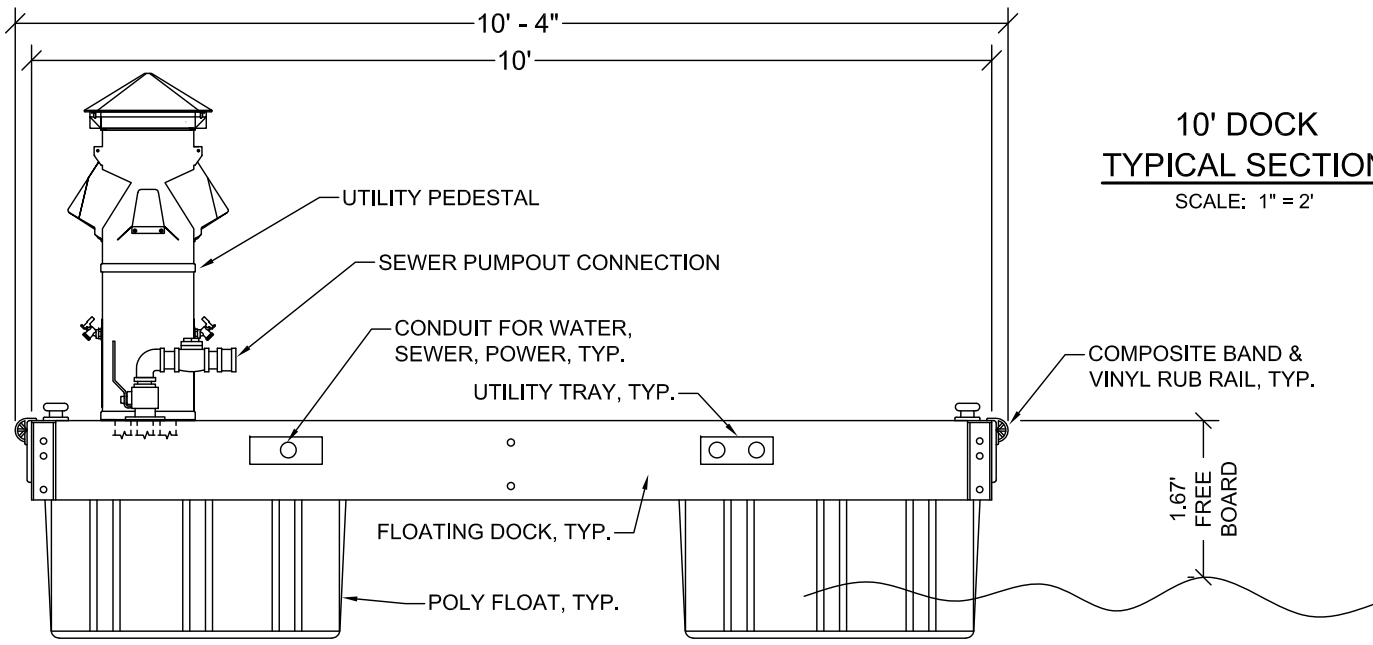

SHEET 14

EMC ENGINEERING SERVICES, INC.
10 Chatham Center South,
Ste 100
Savannah, GA 31405
Ph: (912) 232-6533
Fax: (912) 233-4580
savannah@emc-eng.com
www.emc-eng.com

emc CIVIL MARINE ENVIRONMENTAL

ALBANY, ATLANTA, AUGUSTA, BRUNSWICK,
COLUMBUS, STATESBORO & VALDOSTA

DOCK CROSS SECTIONS

SAVANNAH BOATHOUSE DEVELOPMENT

8020 E. US HWY 80
CHATHAM COUNTY, GEORGIA

Prepared for:
3 SEA SONS, LLC.

PROJECT NO: 18-0143
DRAWN BY: TCB
DESIGNED BY: TCB
SURVEYED BY: YAWN
SURVEY DATE: JAN. 2019
CHECKED BY: JMM
SCALE: 1" = 2'
DATE: MAY 30, 2019